

NEWS
HiPro · DoPro

Trenching

*Tools for
true heroes!*

BETEK
Trenching

MADE IN GERMANY

BETEK

Progress!

In use worldwide: BETEK tungsten carbide tools



1 - Road milling



2 - Surface mining



3 - Stabilising



4 - Recycling



5 - Foundation drilling



6 - Crushing and mixing



7 - Horizontal directional drilling HDD



8 - Mining



9 - Trenching



10 - Tunnelling



11 - Hydraulic milling cutters



12 - Forest mulching



13 - Agriculture



14 - Rail track construction



15 - TungStuds

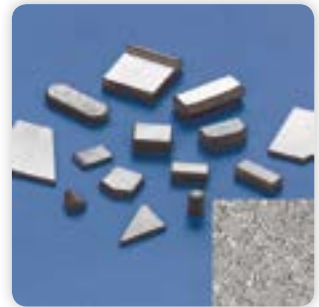

16 - Abrasive wear protection

Use innovative tool systems from Betek – and you'll make good progress with above-average daily productivity! The contours of Betek tools and the grade of tungsten carbide used are always tailored to the job at hand. This ensures a long service life and minimal tool changes.

Progress well with wear-resistant grades of tungsten carbide

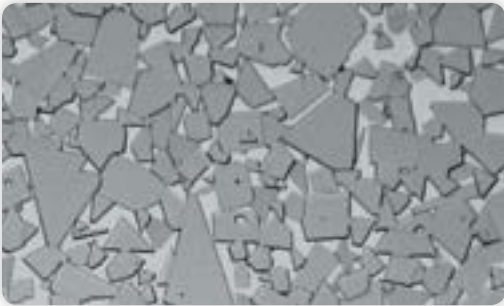

Cross-section through grade B20G tungsten carbide, as used, for example, for trenching

Tungsten carbide and steel – firmly bonded for extreme demands

Steel and carbide are two materials with totally different expansion coefficients when subjected to heat. Nevertheless, it is of steel and tungsten carbide that our tools are made, with tungsten carbide for the wear-resistant tip, and steel for the tool shank. Since tools reach high temperatures during use, extreme tensile stresses are generated. These stresses are absorbed by a special brazing material that joins the tungsten carbide tip to the steel section.

We have developed our own methods and systems for this brazing process, which is carried out on fully automated machines with the process covered in an inert protective gas. Manufacturing parameters are fully monitored and documented to ensure consistent quality. Afterwards, brazing shear strengths are checked to ensure that our “Masters of the construction site” lose no time due to broken tools!



Monitored manufacturing on the fully automated soldering machine



The soldering process to permanently bond tungsten carbide and steel

How our high-tech tools are made

Customer service



- Cost-effective client solutions based on flexible structures
- Tailored, fast response to client requirements

Development & design



- Speedy creation of samples and prototypes
- Competitive prices thanks to close collaboration with all areas of production

Tungsten carbide manufacturing



- Raw materials of high purity used for great strength
- Consistently high, pore-free tungsten carbide quality produced through an exact process resulting from years of experience and know-how

The soldering side of production



Production equipment and processes specially developed to the utmost degree of perfection by experts in combining tungsten carbide and steel

Automation



Able to compete on the world market by virtue of a high degree of automation and flexible manufacturing plants

Quality assurance



Permanent checking of quality in accordance with DIN ISO 9001:2000 and DIN EN ISO 14001 along the entire production chain all the way to the construction site

Training



User training sessions at Betek or on the construction site itself to ensure long-term economic success and client satisfaction

Logistics



Able to react quickly thanks to:

- The use of cutting edge IT and optimum logistics links
- Standard products kept in store

The right tool for your application



High
machine productivity

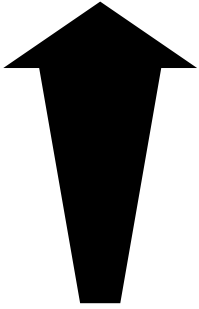

Low
machine productivity

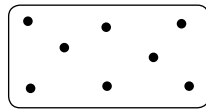
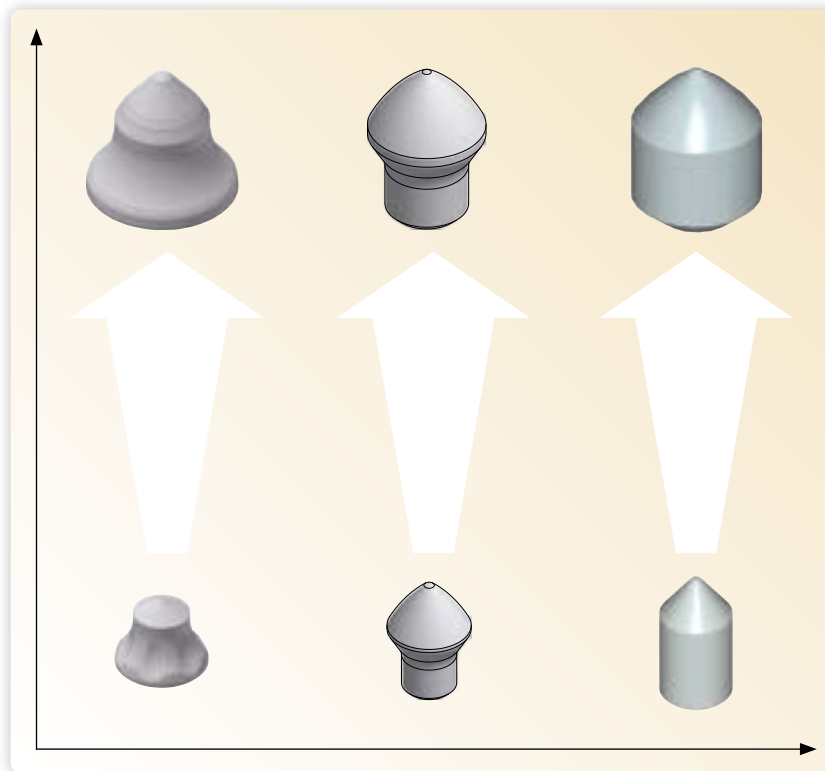

Soft ground

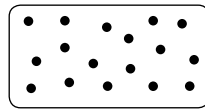

Medium

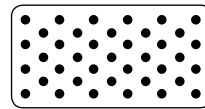

Rock





Tool range

Page

Weld-on Cutter				8 – 9
Round shank cutter bits	Shank system	Ø 11,3 mm / 0,44"		9
Round shank cutter bits	Shank system	Ø 14 mm / 0,55"		10
Round shank cutter bits	Shank system	Ø 18,7 mm / 0,74"		11
Round shank cutter bits	Shank system	Ø 19,4 mm / 0,76"		12 – 14
Round shank cutter bits	Shank system	Ø 22 mm / 0,87"		15 – 19
Round shank cutter bits	Shank system	Ø 25 mm / 1"		20 – 24
Round shank cutter bits	Shank system	Ø 38 / 30 mm - 1,5 / 1,18"		25 – 31
HiPro (High Protection)				32 – 33
DoPro (Double Protection)				34 – 35

Below the pictures of tools on the following pages you will find the following information:

→ **Art-No**

→ Description



← Packaging unit

Dimensions: mm / inches

Welding instructions see:

www.betek.de/en/productprogramme/trenching-userinfo.html



SUPPORT:

trenchtek@betek.de

Tel.: +49 (0) 74 22 / 5 65-590

Weld-on Cutter

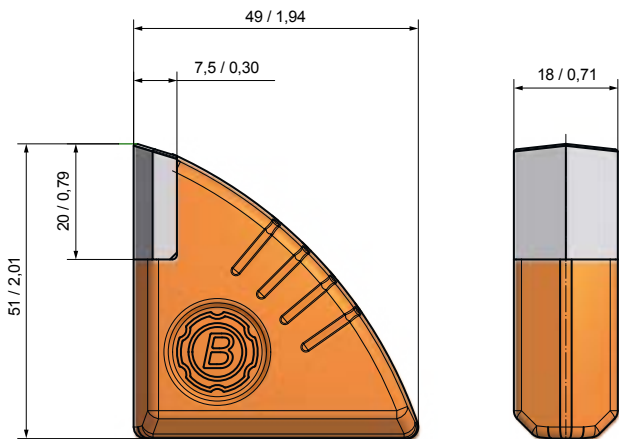

BFZ87
BFZ18/2

50

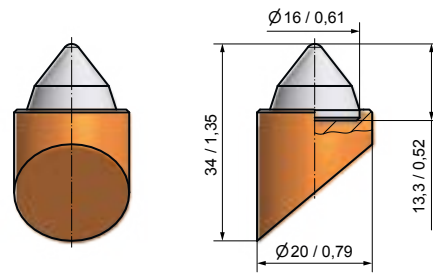

BFZ158
BFZ3

250

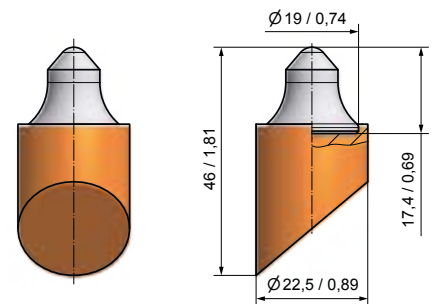

BFZ233
BFZ6

250

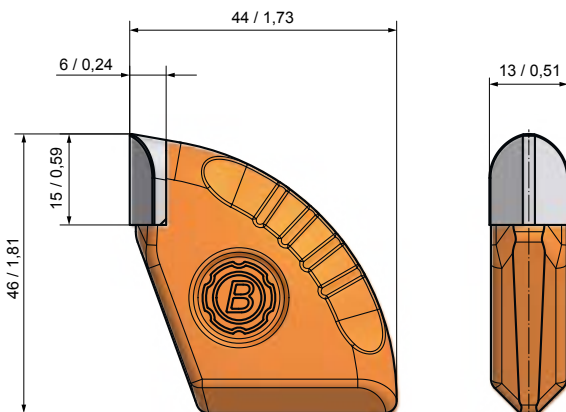

BFZ318
BFZ46x44x13

100

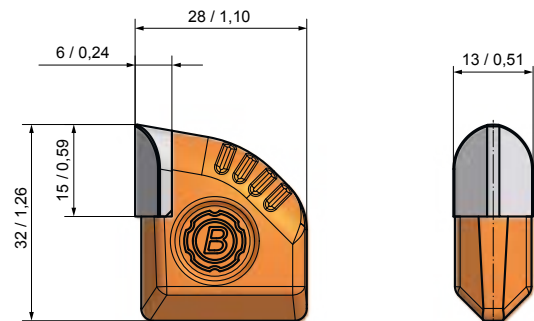

BFZ321
BFZ32x27x13

100

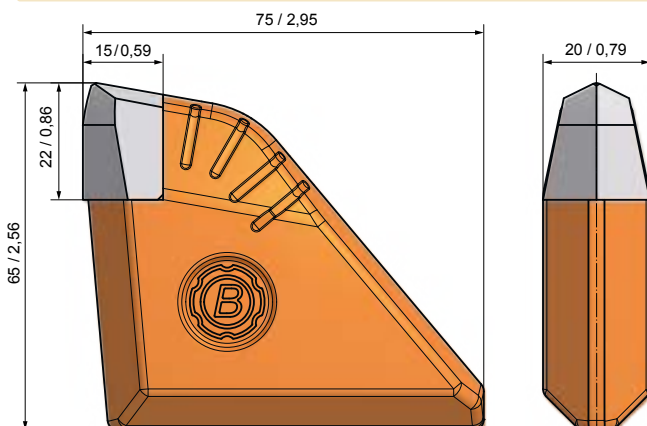

BFZ319
BFZ75x65x20

25

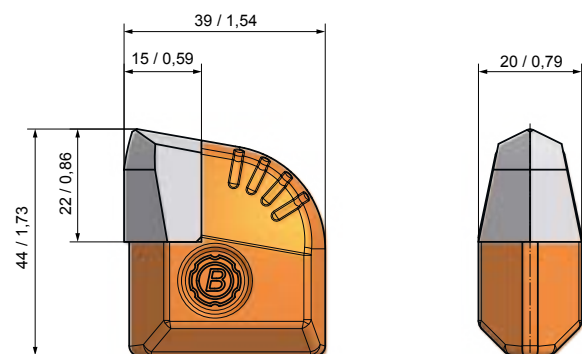

BFZ320
BFZ44x39x22

50

Weld-on Cutter

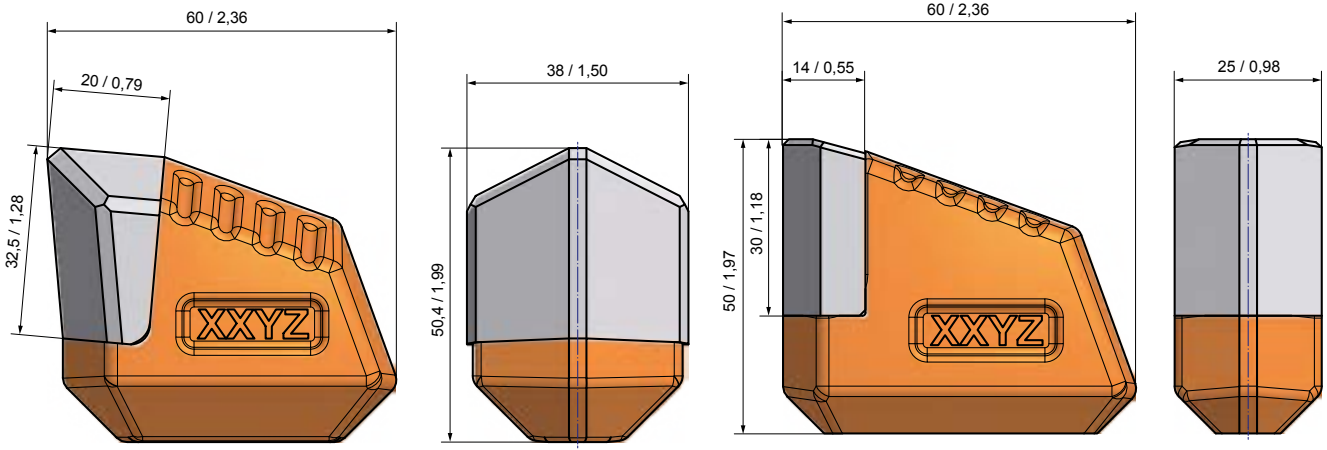



BFZ326
BFZ38/M 

BBM75
BBM25x50 

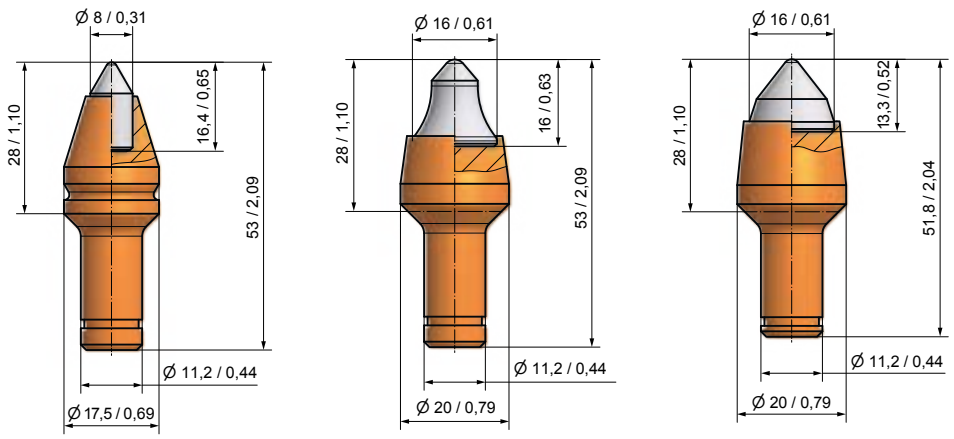
Round shank cutter bits Shank system \varnothing 11,3 mm/0,44" 



BM11
BM8-11.3 

BM10
BM4-11.3 

BM46
BM3-11.3 

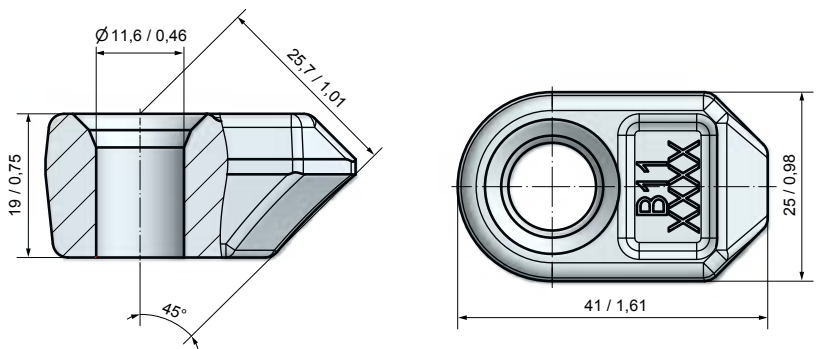

BHR03
B11 

Shank system Ø 14 mm/0,55"

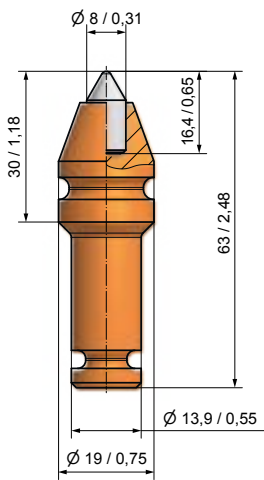

Lock ring SR90

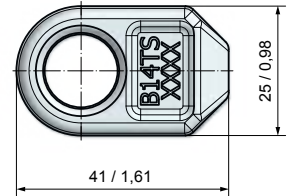
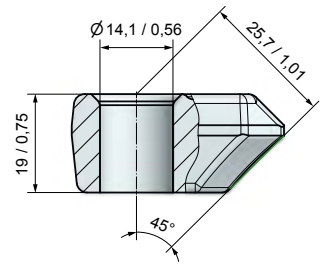
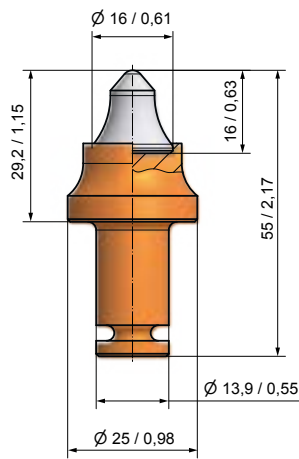
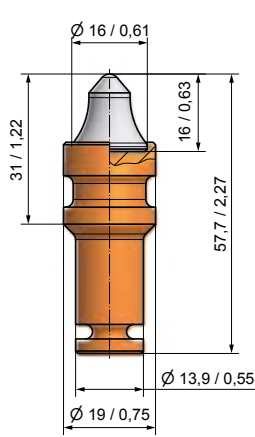

BM84
BM8-14

200

BM44
BM4-14

200

BM76
BM4-14/TS

200

BHR171
B14-TS

200

Shank system Ø 14 mm/0,55"

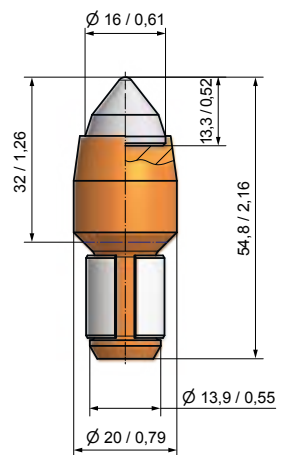
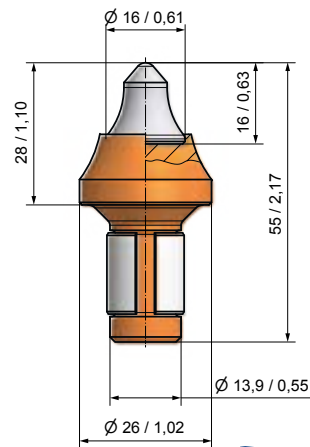
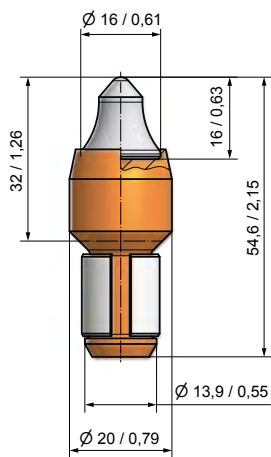
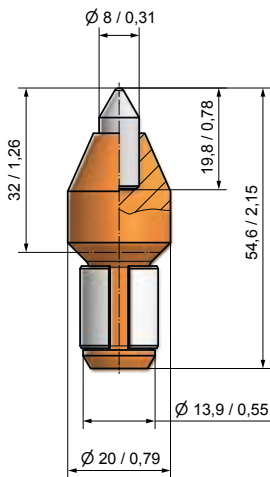

BM56
BM8-14/2

200

BM55
BM4-14/2

200

BM82
BM4-14/3

200

BM60
BM3-14/H

200



BZ44
Bit extractor

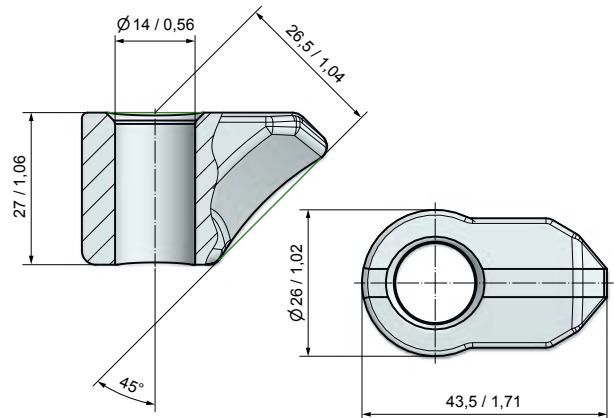

BHR109
B14

150

Shank system Ø 18,7 mm/0,74"

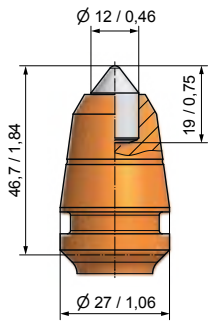

BTR02
B43HDK12

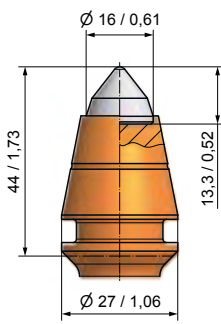

BTR03
B43/3

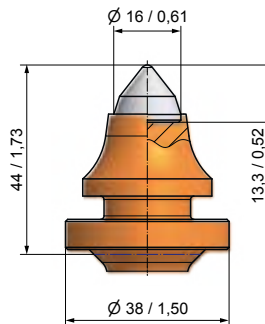

BTR09
BG19K-60.3844

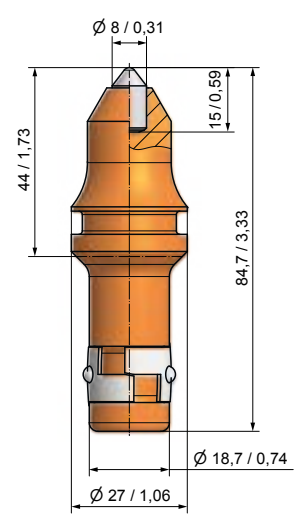

BTR01
B43K8



Shank system Ø 18,7 mm/0,74"

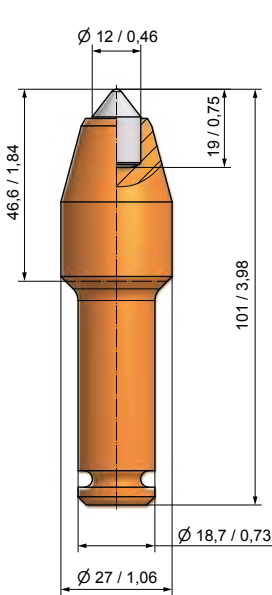

BTR07
B43K12KS

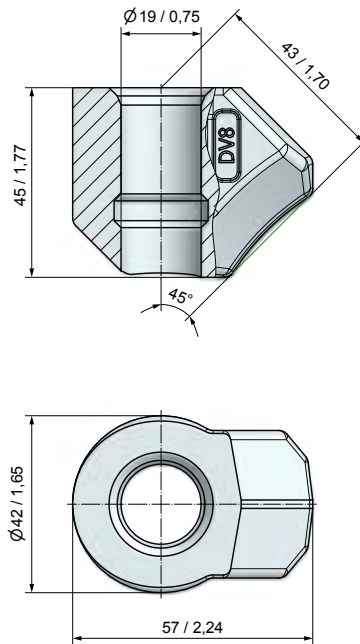

BHR20
DV8

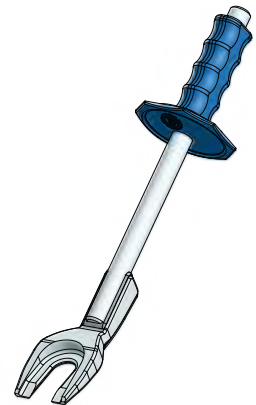

BZ42
Bit puller



Lock ring SR80



BZ38
Wedge puller

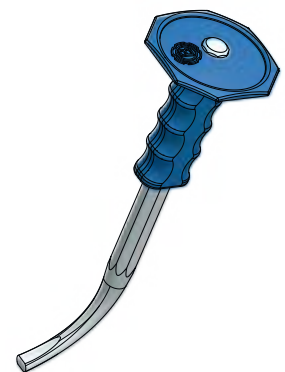

BZ43
Bit extractor

Shank system Ø 19,4 mm/0,76"

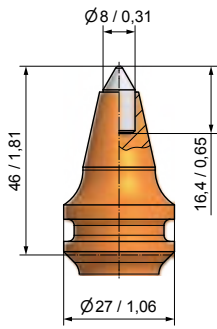

BSK19
B1K8-K

50

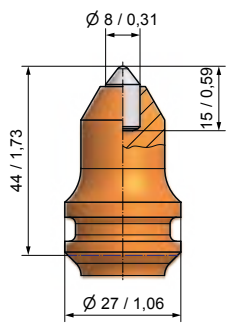

BSK22
B1K8-K/2

50

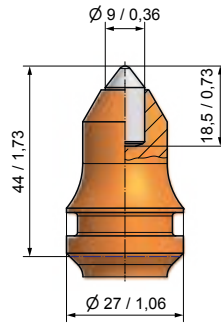

BSK15
B1K9-K

50

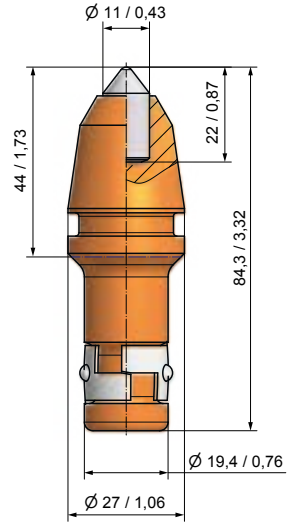

BSK16
B1HDK11-K

50

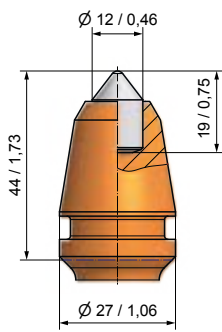

BSK17
B1HDK12-K

50

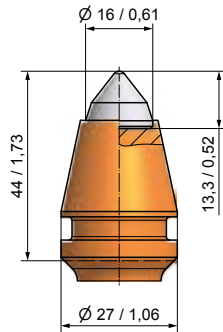

BSK23
B3-K/2

50

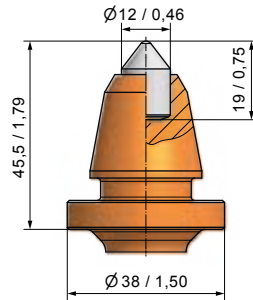

BSK21
B1-12/38-K

50

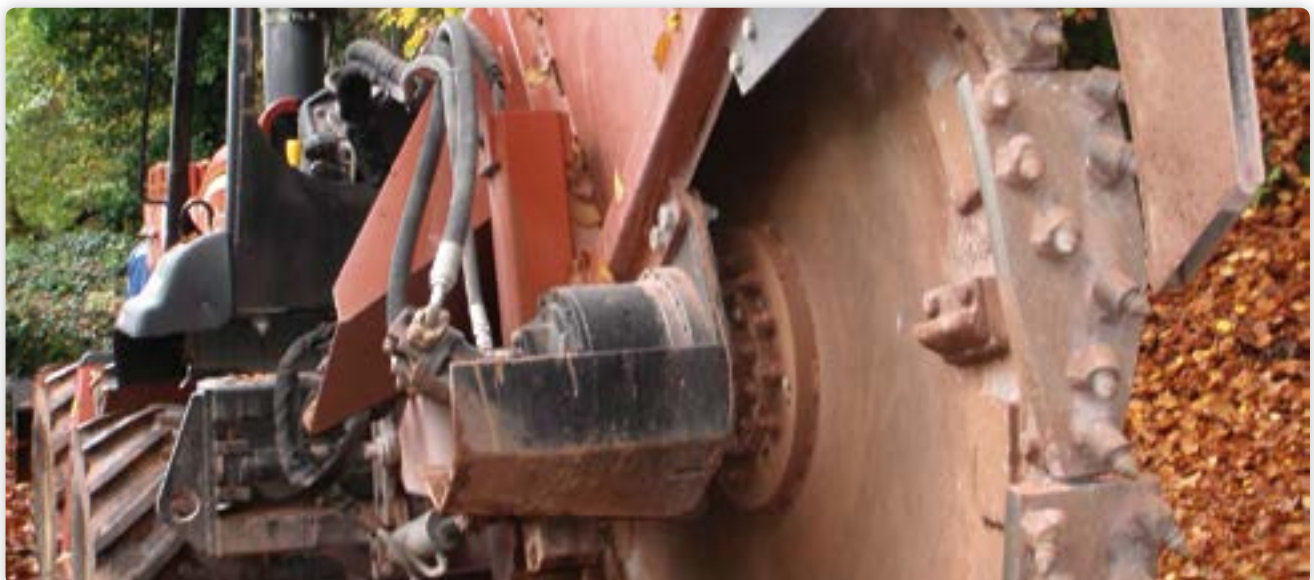

Shank system Ø 19,4 mm/0,76"

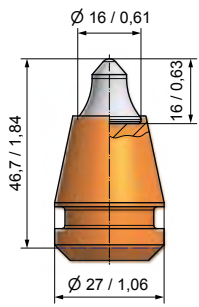

BSH204
B4

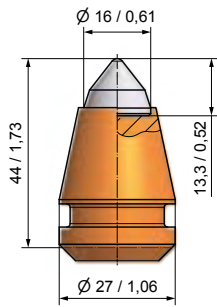

BSH09
B3

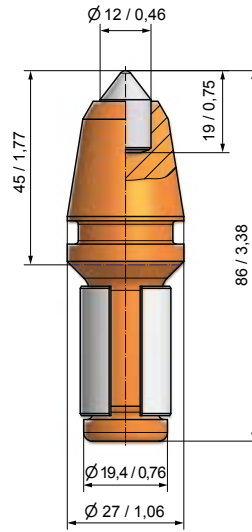

BSH05
B1HDK12

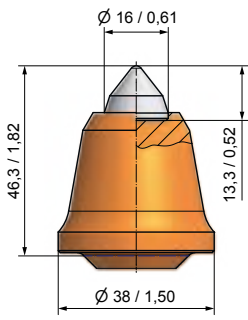

BSH211
B3/38

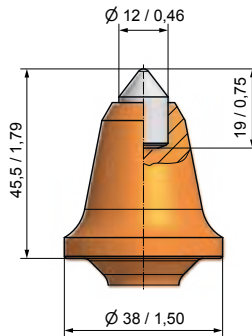

BSH210
B1-12/38



Shank system Ø 19,4 mm/0,76"

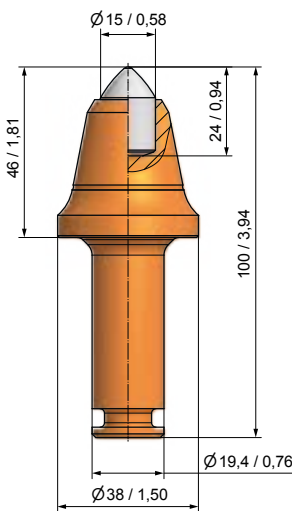

BC68
BG20F-15.3846

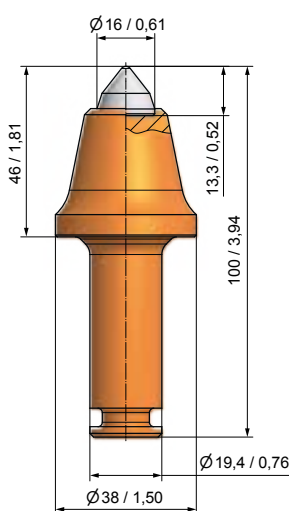

BC26
B3KS

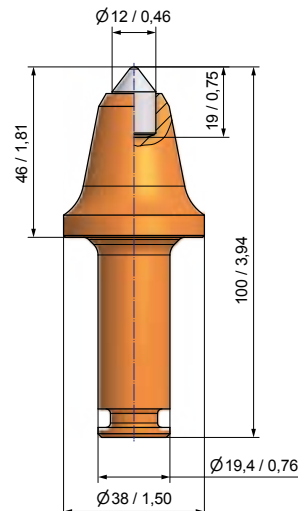

BC82
BG20F-12.3846



Lock ring SI36

Shank system Ø 19,4 mm / 0,76"

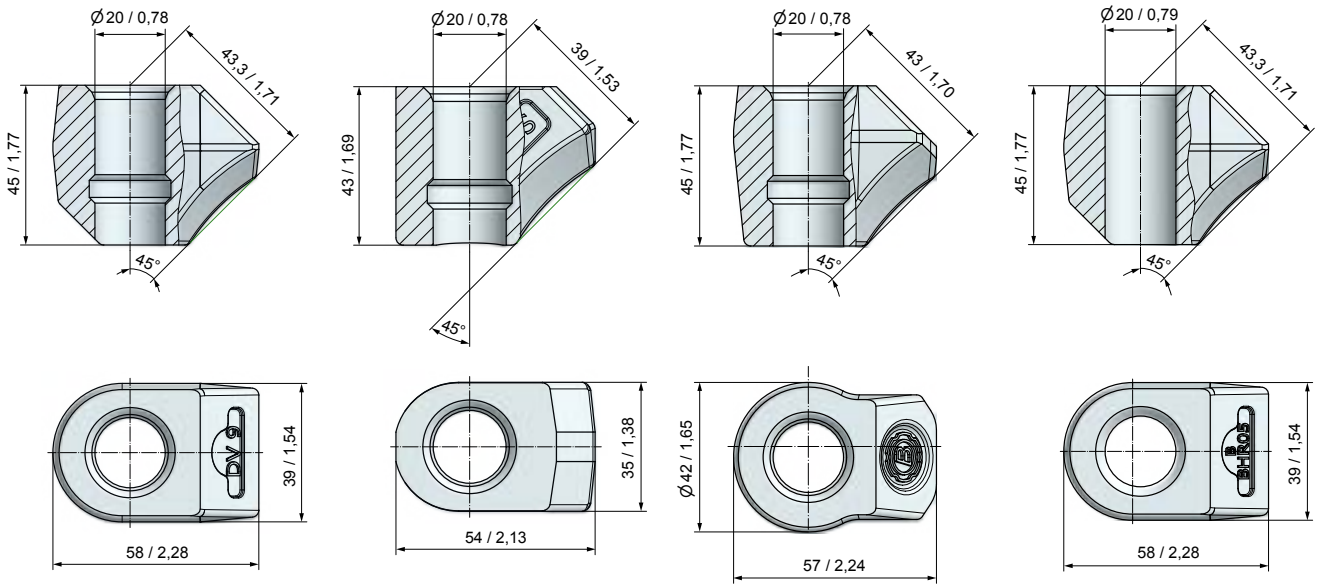

BHR07
DV9

40

BHR164
DV9-S

50

BHR12
DV12

40

BHR05
B10

40

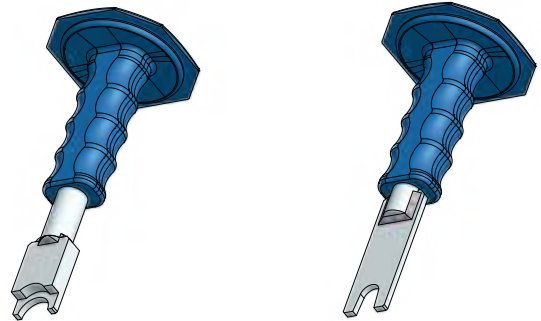

for lock ring SI36

BZ33
Assembly tool

BZ31
Disassembly tool

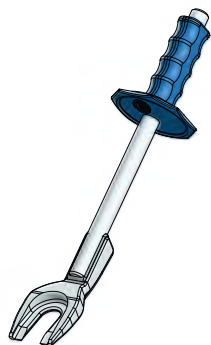

BZ42
Bit puller



BZ43
Bit extractor



BZ38
Wedge puller

Shank system Ø 22 mm/0,87"

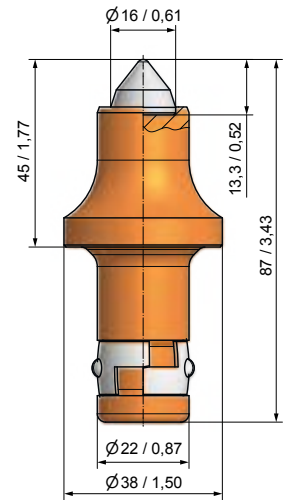

BC58
B3S/22-K



Shank system Ø 22 mm/0,87"

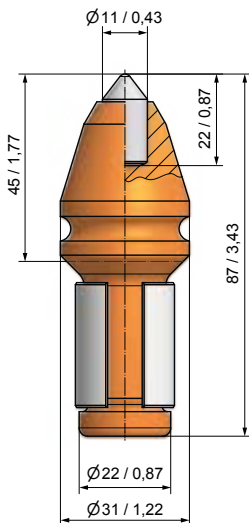

BC05
B1HDK11/22

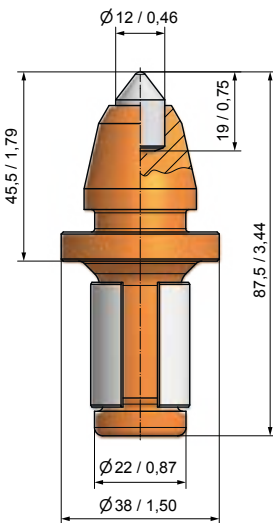

BC60
B1-12/22

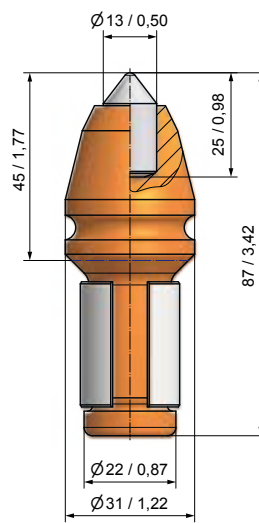

BC06
B1HDK13/22

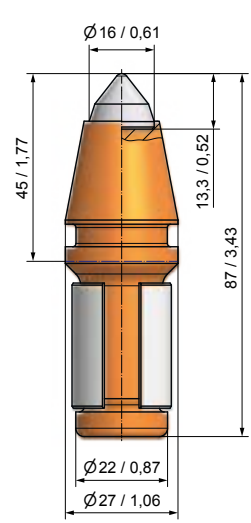

BC49
B3/22

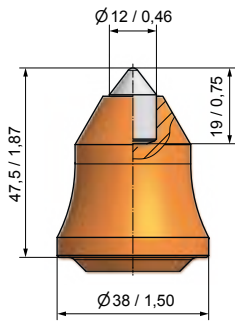

Shank system $\varnothing 22 \text{ mm}/0,87''$ **BC64**

B1-12/22-B

40

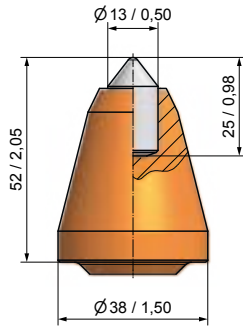
**BC14**

B1HDS38/13/22

40

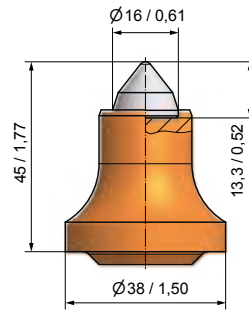
**BC41**

B3S/22

50

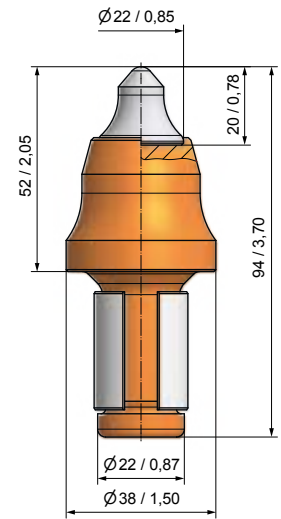
**BC03**

B8S/22

40

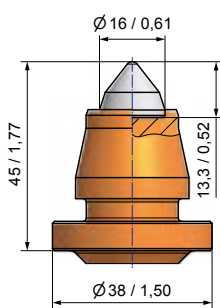
**BC81**

BG22H-60.3845

50

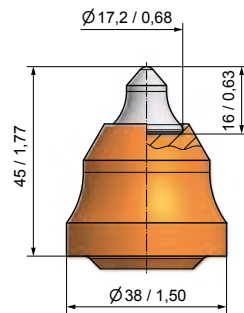
**BC04**

B5S/22

50

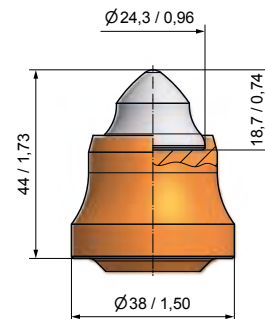
**BC43**

B9/22

40



Shank system Ø 22 mm/0,87"

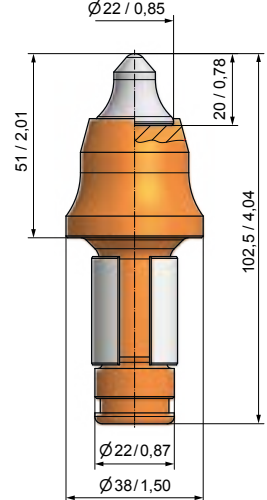
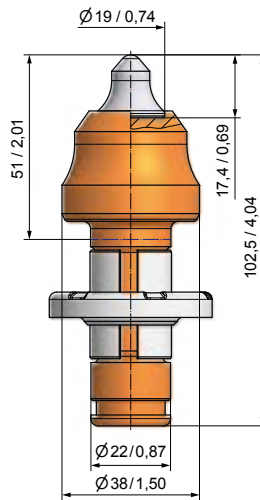
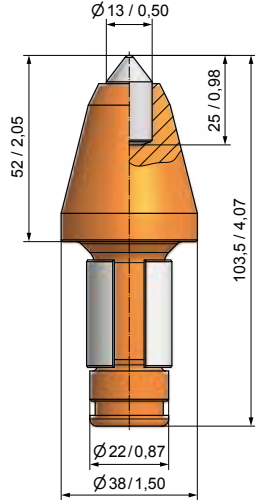
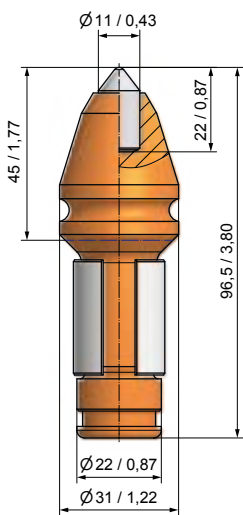

additional lock ring SR61

BC01
B1HDK11/22S



BC15
B1HD38/13/22/S



BC61
B6V/22/S



BC44
B8/22-S



Shank system Ø 22 mm/0,87"

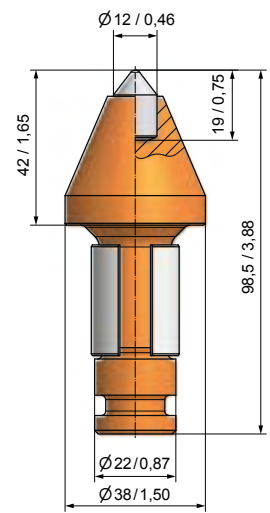
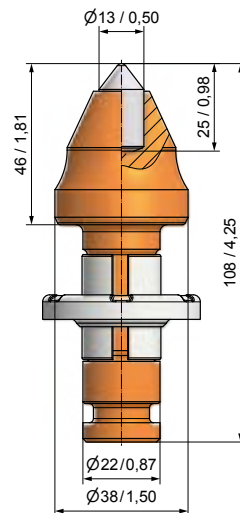
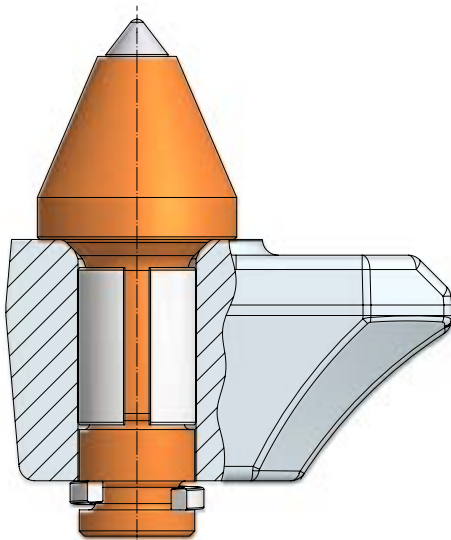

BC79
BG 22 HF-13.3851



BC36
B1-12/22/SI26



additional lock ring SI26

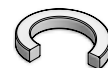

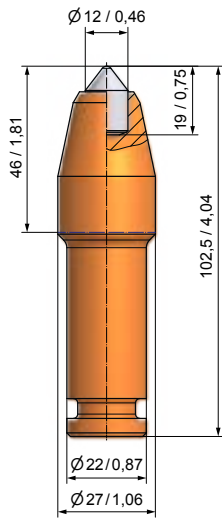
Shank system $\varnothing 22 \text{ mm}/0,87''$ 

BC39

40

B1-12KS22

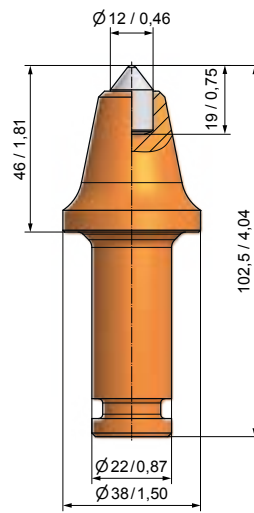

BC62

40

B1-12/38KS22

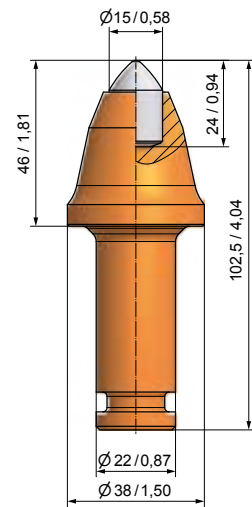

BC77

40

BG22F-15.3846

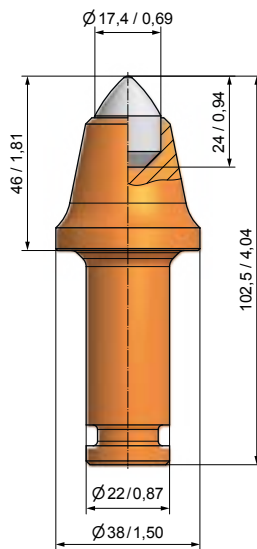

BC56

40

B1-17KS22

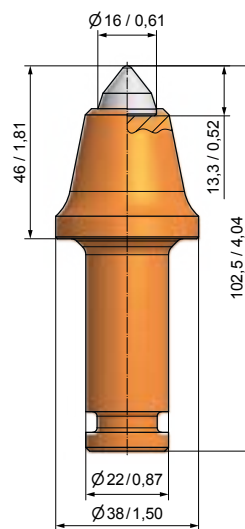

BC33

40

B3KS22

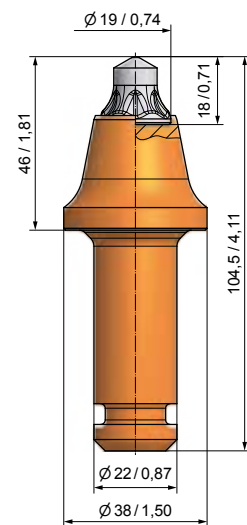

BC78

40

BG22F-65.3846

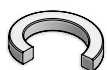

Lock ring SI26



Shank system Ø 22 mm/0,87"

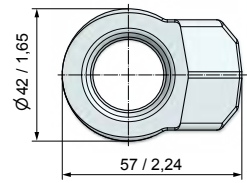
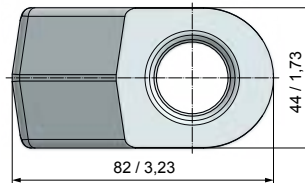
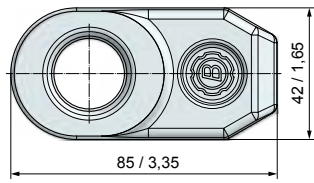
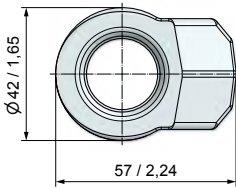
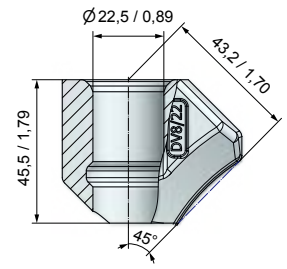
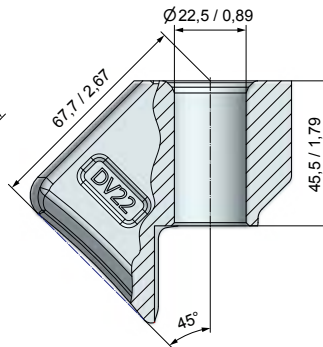
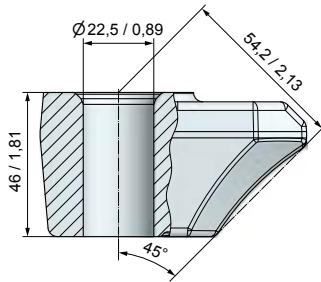
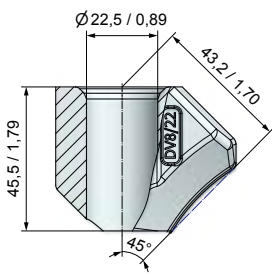

BHR27 40
DV8/22

BHR120 20
B22S

BHR30 15
DV22

BHR176 40
DV8/22-K

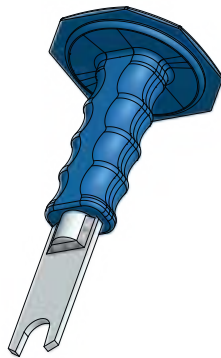

for lock ring SI26

BZ41
Assembly tool

BZ32
Disassembly tool

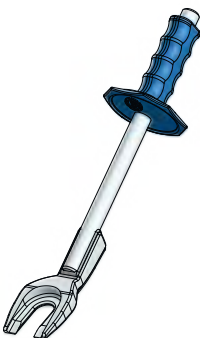

BZ42
Bit puller

BZ43
Bit extractor

BZ38
Wedge puller

Shank system Ø 25 mm / 1"

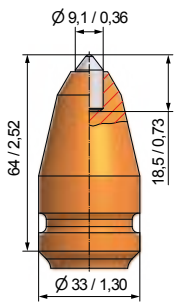

30

BTK01
B40K9

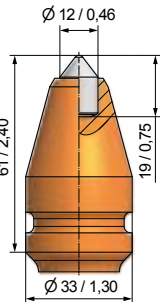

30

BTK03
B40HDK12

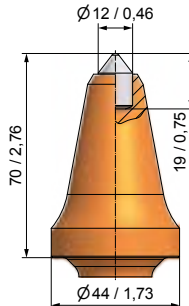

20

BTK141
BG25K-12.4470A

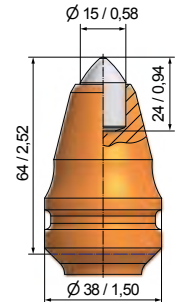

Stock items

30

BTK10
B40HDS

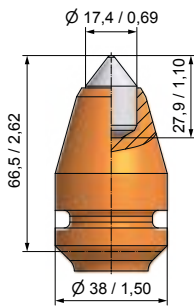

25

BTK70
B40K17,5

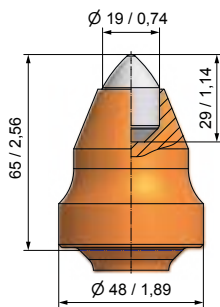

Stock items

25

BTK54
B40HDS19

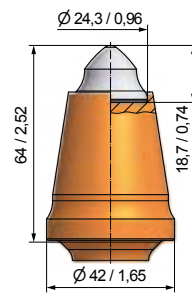

Stock items

25

BTK87
B40/9

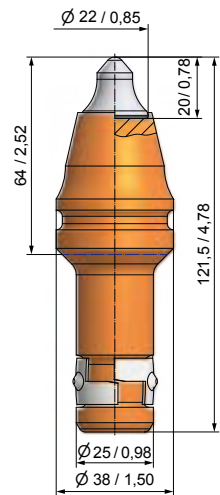

30

BTK20
BG25K-67.3864

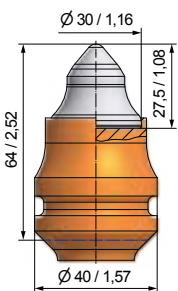

25

BTK23
B40HBL

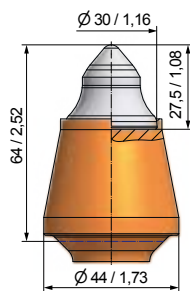

25

BTK26
B40-J1-HBL

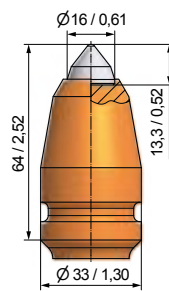

30

BTK16
B40/3

Shank system Ø 25 mm / 1"

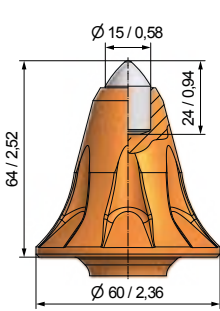

BTK81

B40HDS/60

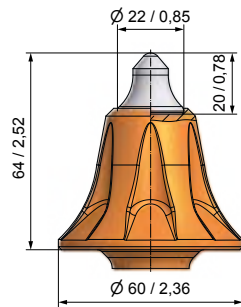

BTK80

B4022/60

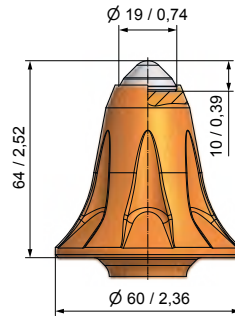

BTK82

B40SG/60

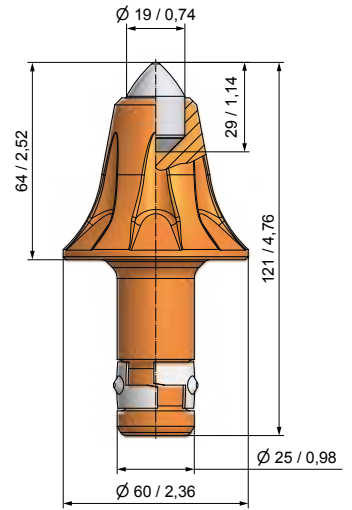

BTK89

BG25K-19.6064



Shank system Ø 25 mm / 1"

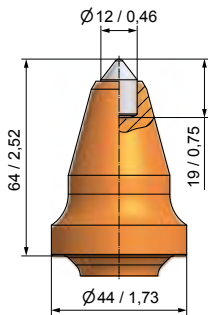

BTK142

BG25F-12.4464A

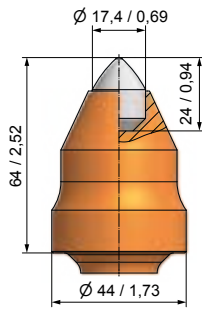

BTK11

BG25F-17.4464

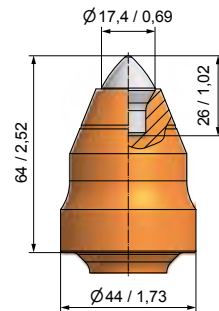

BTK135

BG25F-70.4464

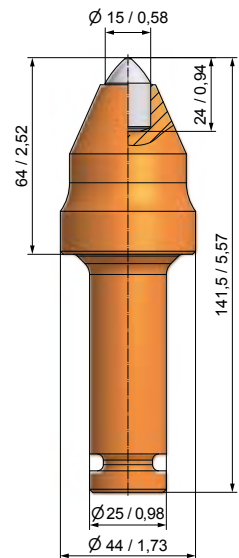

Stock items

BTK29

BG25F-15.4464

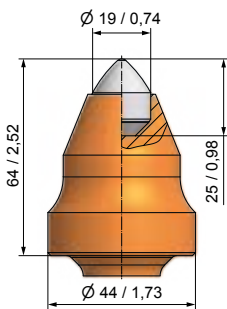

BTK14

BG25F-19.4464

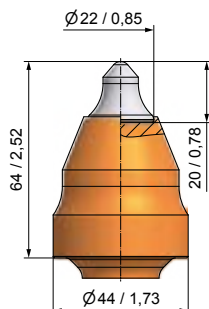

BTK43

BG25F-67.4464



Lock ring SI79 / K

Stock items

Shank system Ø 25 mm / 1" Gauge 64 mm / 2,5"

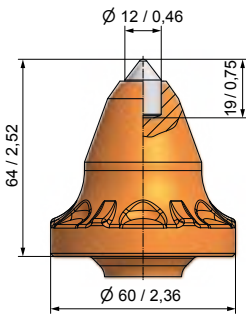

Stock items

BTK114

BG25F-12.6064

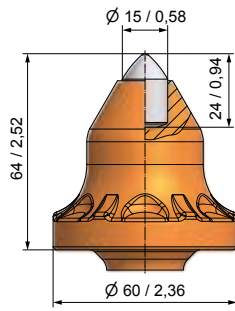

Stock items

BTK120

BG25F-15.6064

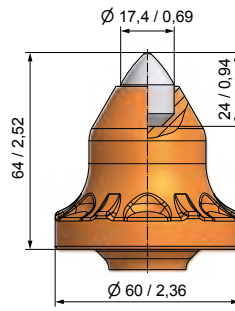

BTK121

BG25F-17.6064

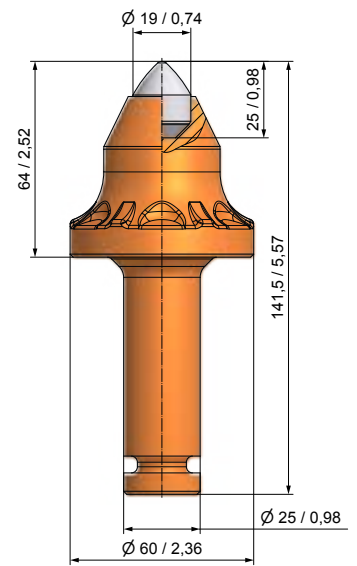

Stock items

BTK122

BG25F-19.6064

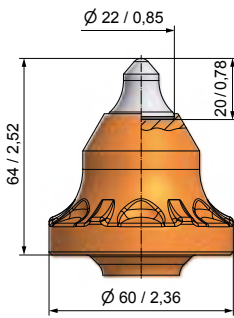

BTK123

BG25F-67.6064

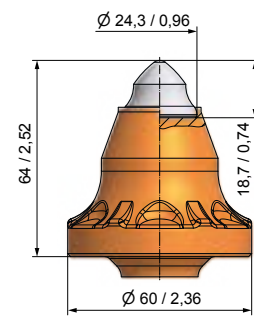

BTK124

BG25F-68.6064

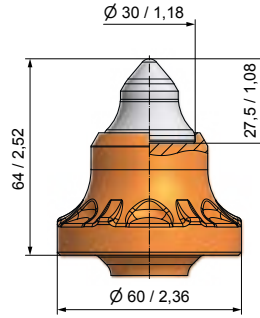

BTK125

BG25F-69.6064A



Lock ring SI79 / K

Shank system Ø 25 mm / 1" Gauge 76 mm / 3,0"

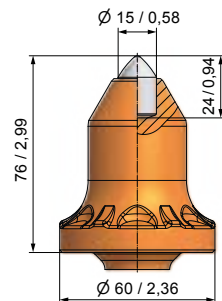

BTK113

BG25F-15.6076

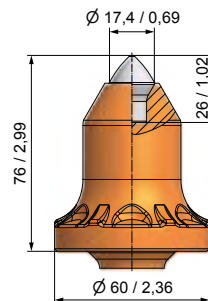

BTK126

BG25F-70.6076A

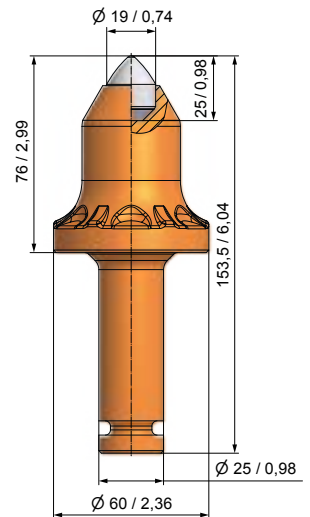

BTK127

BG25F-19.6076A



Lock ring SI79 / K

Shank system Ø 25 mm / 1"

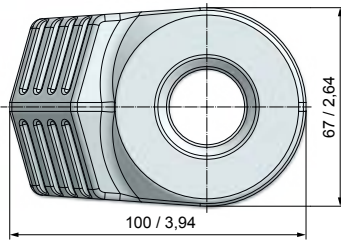
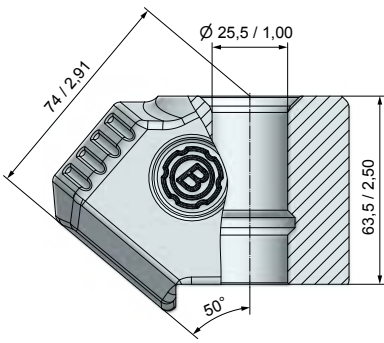

BHR186
B25.6750

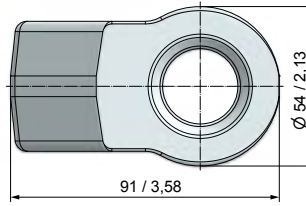
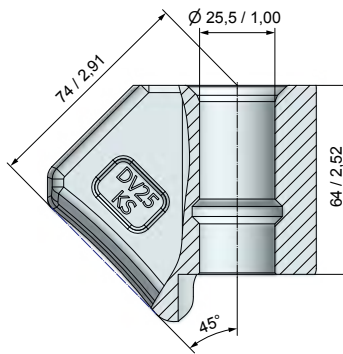

BHR121
DV25KS

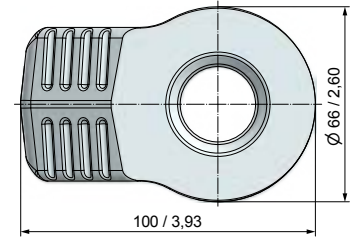
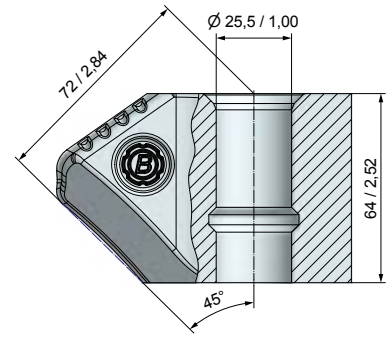

BHR34
DV40VS

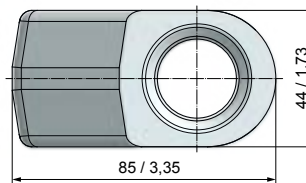
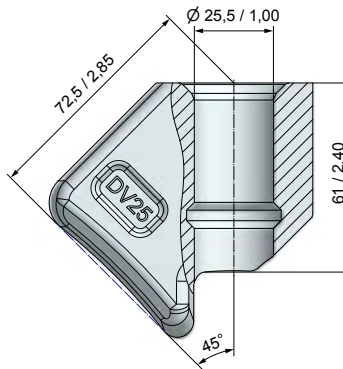

BHR31
DV25

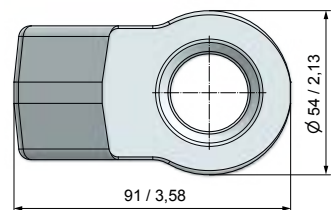
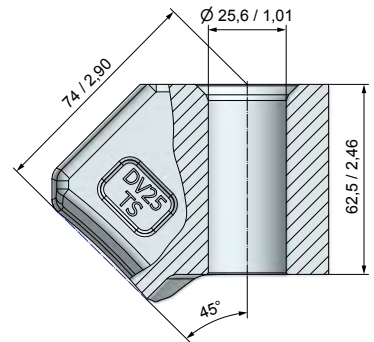

BHR145
DV25TS



Shank system Ø 25 mm / 1"



for lock ring SI79 / K

BZ37
Assembly tool

BZ36
Disassembly tool

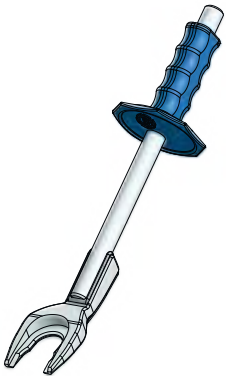

BZ22
Bit puller



BZ43
Bit extractor



BZ38
Wedge puller



Shank system Ø 38/30 mm - 1,5/1,18" Gauge 64 mm/2,5"

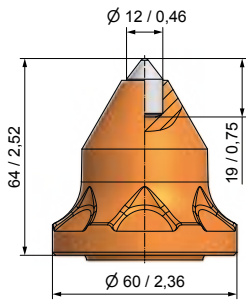

BKS165
BS38W-12.6064A

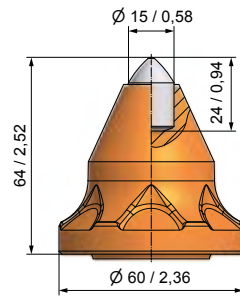

BKS144
BS38W-15.6064

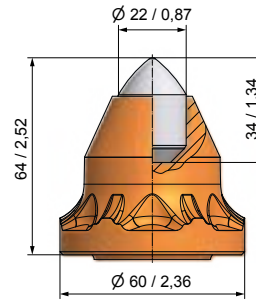

BKS162
BS38W-22.6064

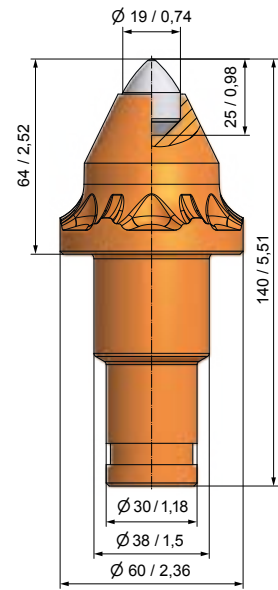

Stock items

BKS151
BS38W-19.6064

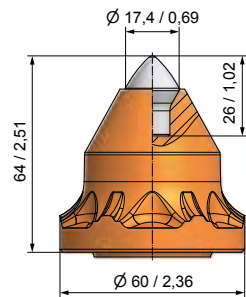

BKS163
BS38W-70.6064

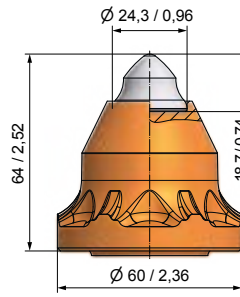

BKS160
BS38W-68.6064

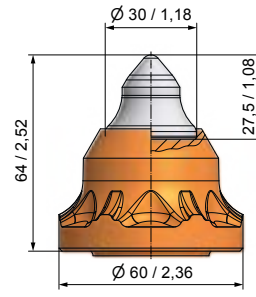

BKS161
BS38W-69.6064



Shank system Ø 38/30 mm - 1,5/1,18" Gauge 70 mm/2,75"

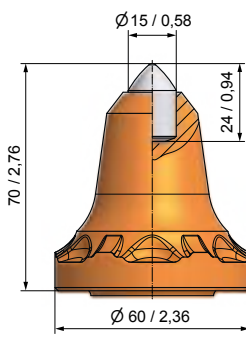

BKS168
BS38W-15.6070

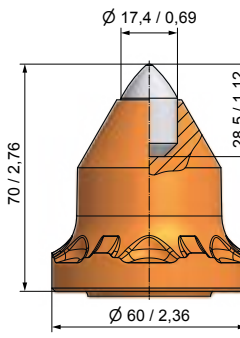

BKS166
BS38W-17.6070

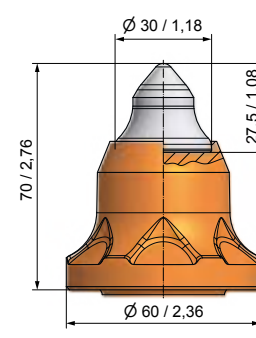

BKS167
BS38W-69.6070A



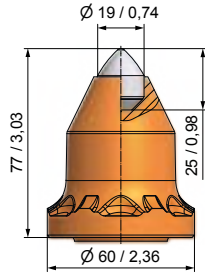
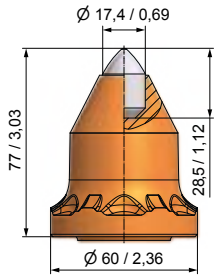
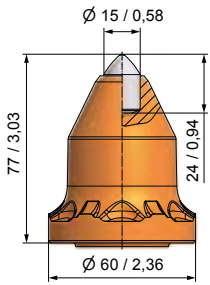

Shank system Ø 38/30 mm - 1,5/1,18" Gauge 77 mm/3,0"



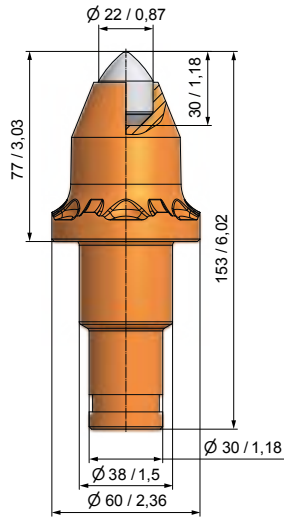

Stock items



BKS169 
BS38W-15.6077A

BKS171 
BS38W-17.6077

BKS172 
BS38W-19.6077

BKS170 
BS38W-22.6077



Shank system Ø 38/30 mm - 1,5/1,18" Gauge 77 mm/3,0"

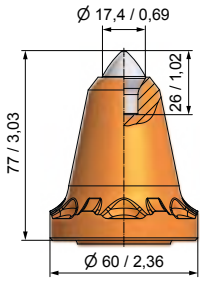

Stock items

BKS174

BS38W-70.6077

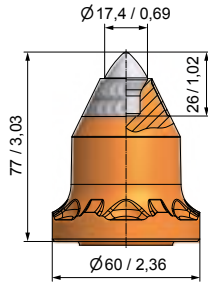

BKS193

BS38W-70.6077P

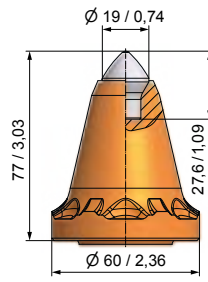

Stock items

BKS175

BS38W-72.6077

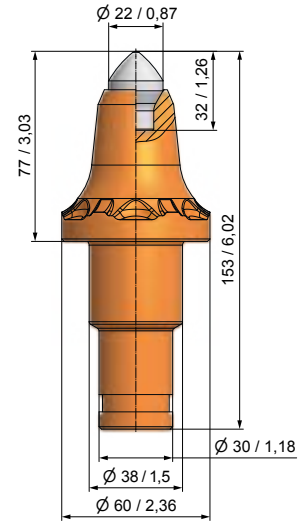

BKS158

BS38W-73.6077

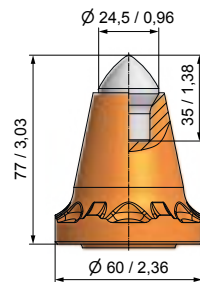

BKS176

BS38W-71.6077

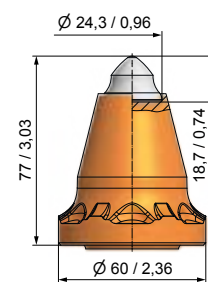

BKS178

BS38W-68.6077

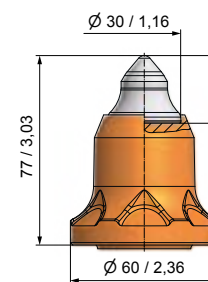

BKS177

BS38W-69.6077A



Shank system Ø 38/30 mm - 1,5/1,18" Gauge 89 mm/3,5"

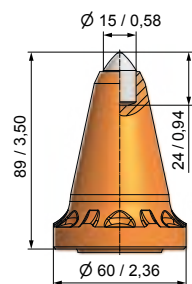

BKS179

BS38W-15.6089

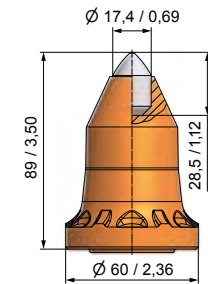

BKS180

BS38W-17.6089

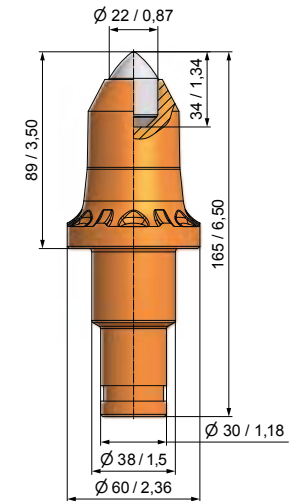

BKS183

BS38W-22.6089

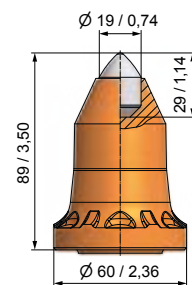

BKS181

BS38W-19.6089

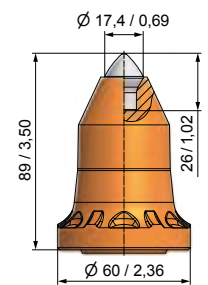

BKS182

BS38W-70.6089



Shank system Ø 38/30 mm - 1,5/1,18" Gauge 64 mm/2,5"

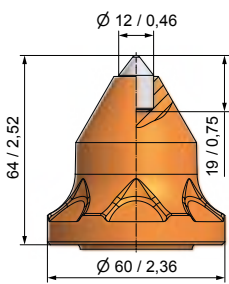

BKF27



BS38F-12.6064

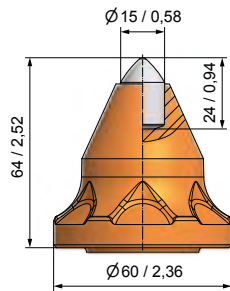

BKF24



BS38F-15.6064

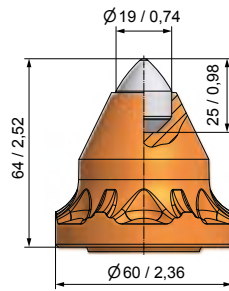

Stock items

BKF22



BS38F-19.6064

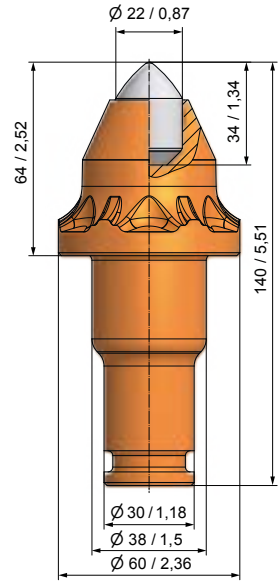

BKF26



BS38F-22.6064

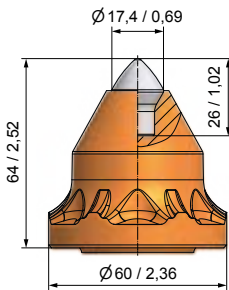

BKF25



BS38F-70.6064

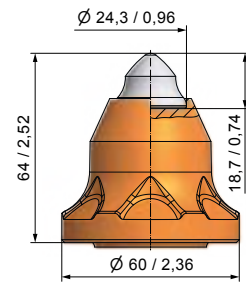

BKF28



BS38F-68.6064

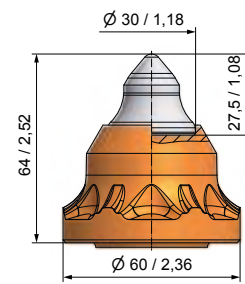

BKF29



BS38F-69.6064

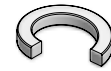

Lock ring SI35 / 22



Shank system Ø 38/30 mm - 1,5/1,18" Gauge 77 mm/3,0"

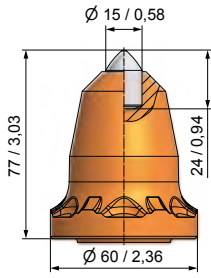

BK F32

BS38F-15.6077

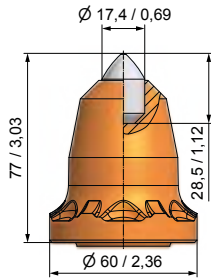

BK F33

BS38F-17.6077

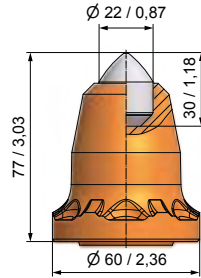

BK F31

BS38F-22.6077

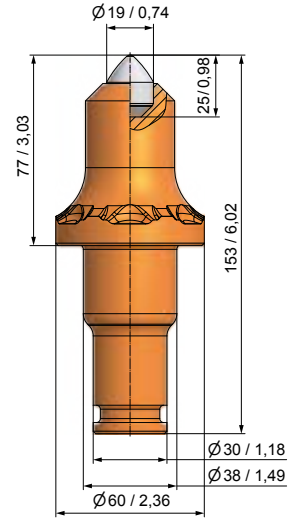

Stock items

BK F30

BS38F-19.6077

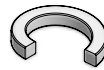

Lock ring SI35 / 22

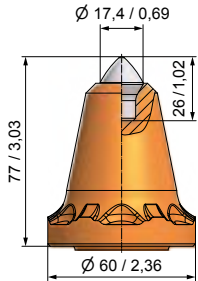

Stock items

BK F40

BS38F-70.6077

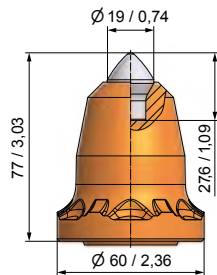

BK F39

BS38F-72.6077

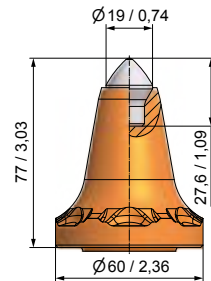

BK F39S

BS38F-72.6077A

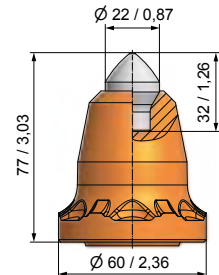

BK F38

BS38F-73.6077

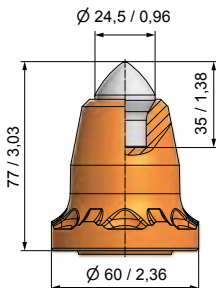

Stock items

BK F36

BS38F-71.6077

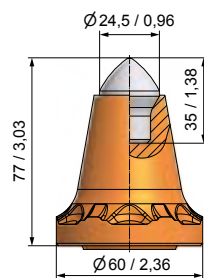

BK F36S

BS38F-71.6077A

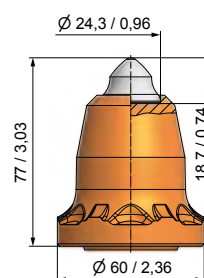

BK F34

BS38F-68.6077

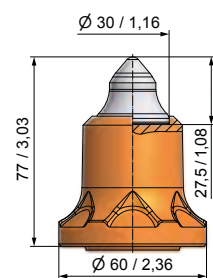

BK F37

BS38F-69.6077



Shank system Ø 38/30 mm - 1,5/1,18" Gauge 89 mm/3,5"

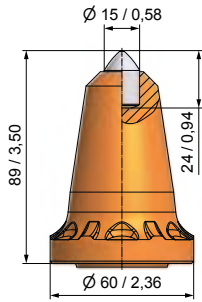

BKF41

BS38F-15.6089

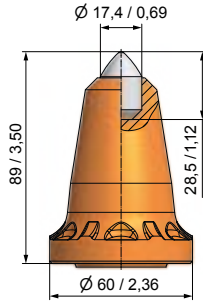

BKF42

BS38F-17.6089

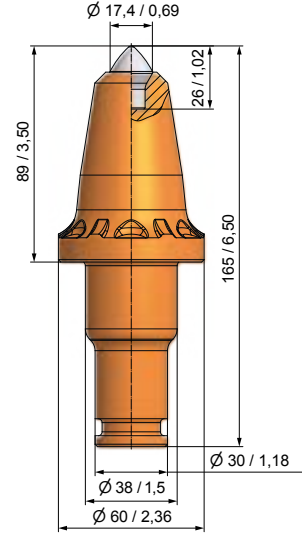

BKF45

BS38F-70.6089

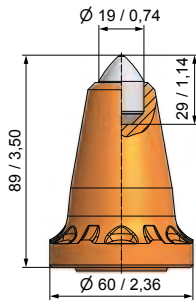

BKF43

BS38F-19.6089

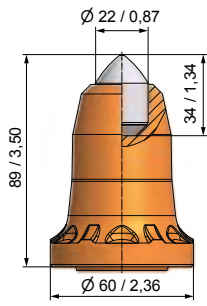

BKF44

BS38F-22.6089

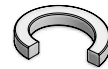

Lock ring SI35 / 22



Shank system Ø 38/30 mm - 1,5/1,18"

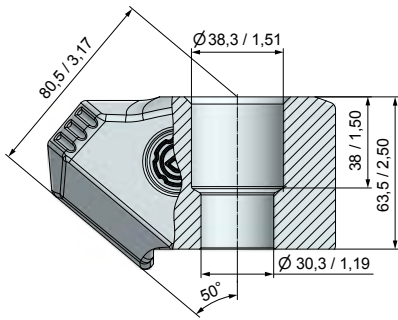

BHR187

B3830.8250



6

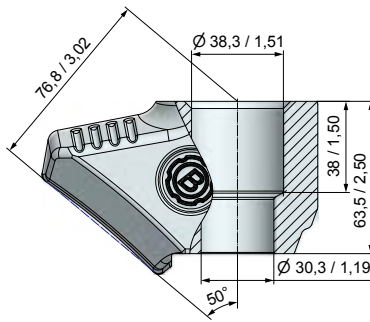

BHR188

B3830.6750



8

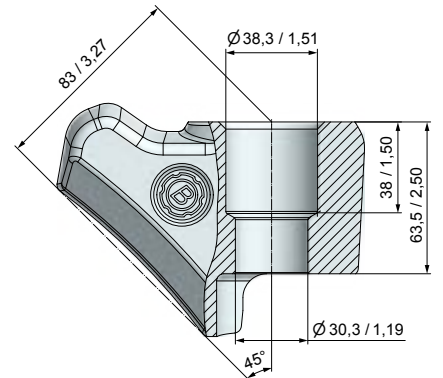

BHR204

B3830.7845



4

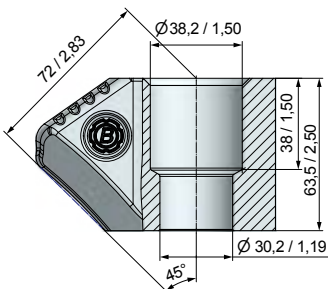
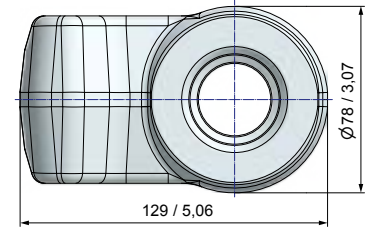
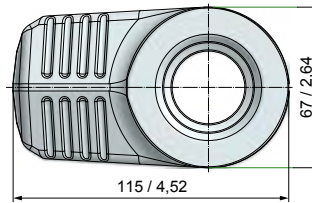
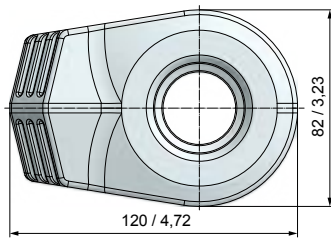

BHR38

B43H



10

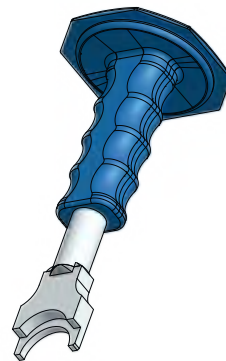
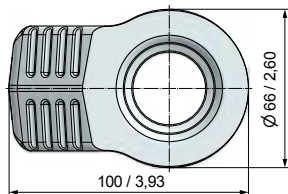

BZ35

Assembly tool

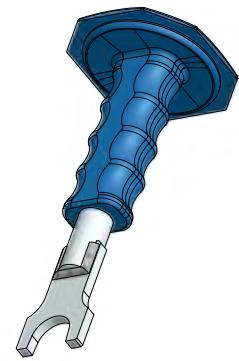

BZ34

Disassembly tool



SI35/22



SRZ02

Plier



BZ39

Wedge puller

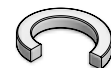

Lock ring

SI35/22



100



Lock ring

SR83



100

Trenching tool series BKF HiPro (High Protection)

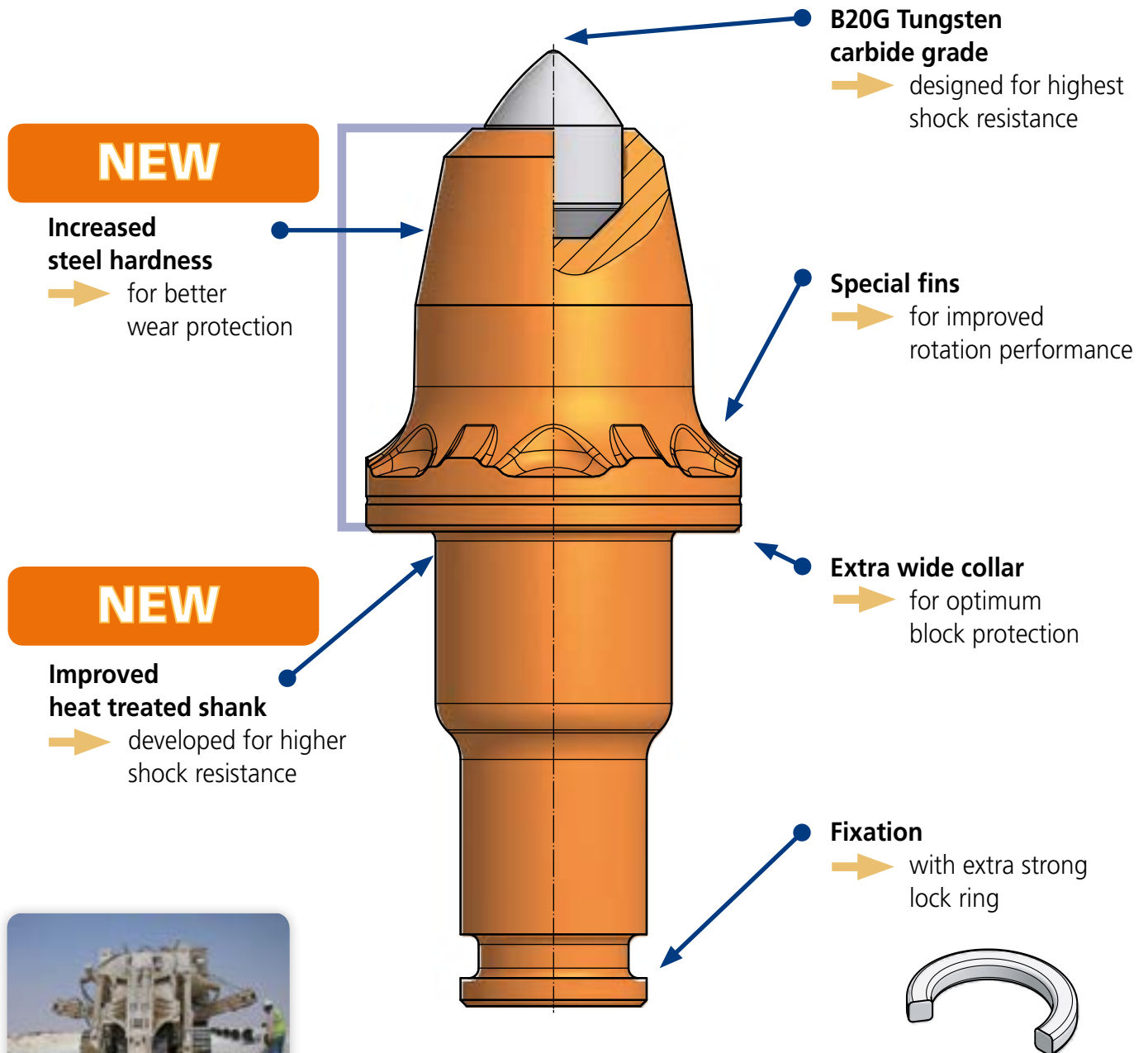

Shank system Ø 38/30 mm - 1,5/1,18" Gauge 64 mm/2,5"

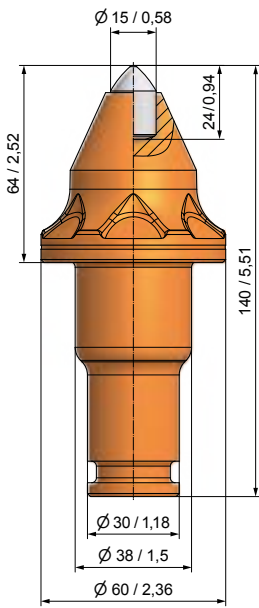

BKF24H 10
BS38F-15.6064H

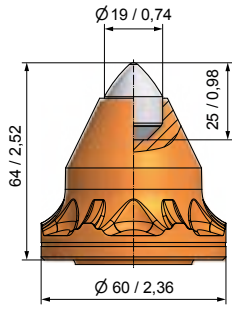

BKF22H 10
BS38F-19.6064H

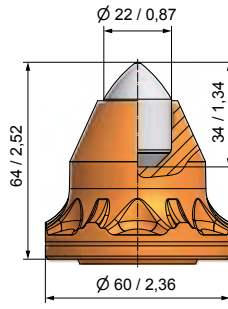

BKF26H 10
BS38F-22.6064H



BZ35
Assembly tool



BZ34
Disassembly tool

Shank system Ø 38/30 mm - 1,5/1,18" Gauge 77 mm/3,0"

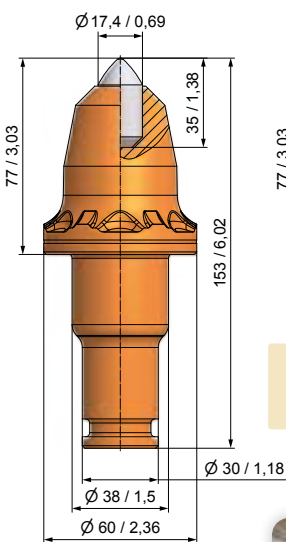

BKF49H 10
BS38F-17.6077AH

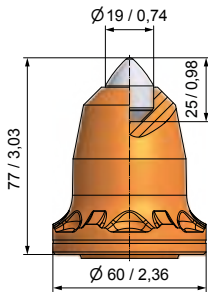

BKF30H 10
BS38F-19.6077H

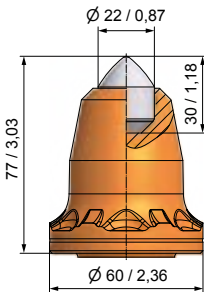

BKF31H 10
BS38F-22.6077H

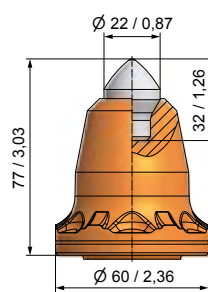

BKF38H 10
BS38F-73.6077H

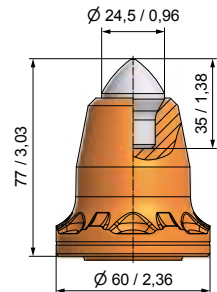

BKF36H 10
BS38F-71.6077H



Trenching tool series BKF DoPro (Double Protection)

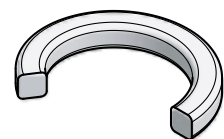
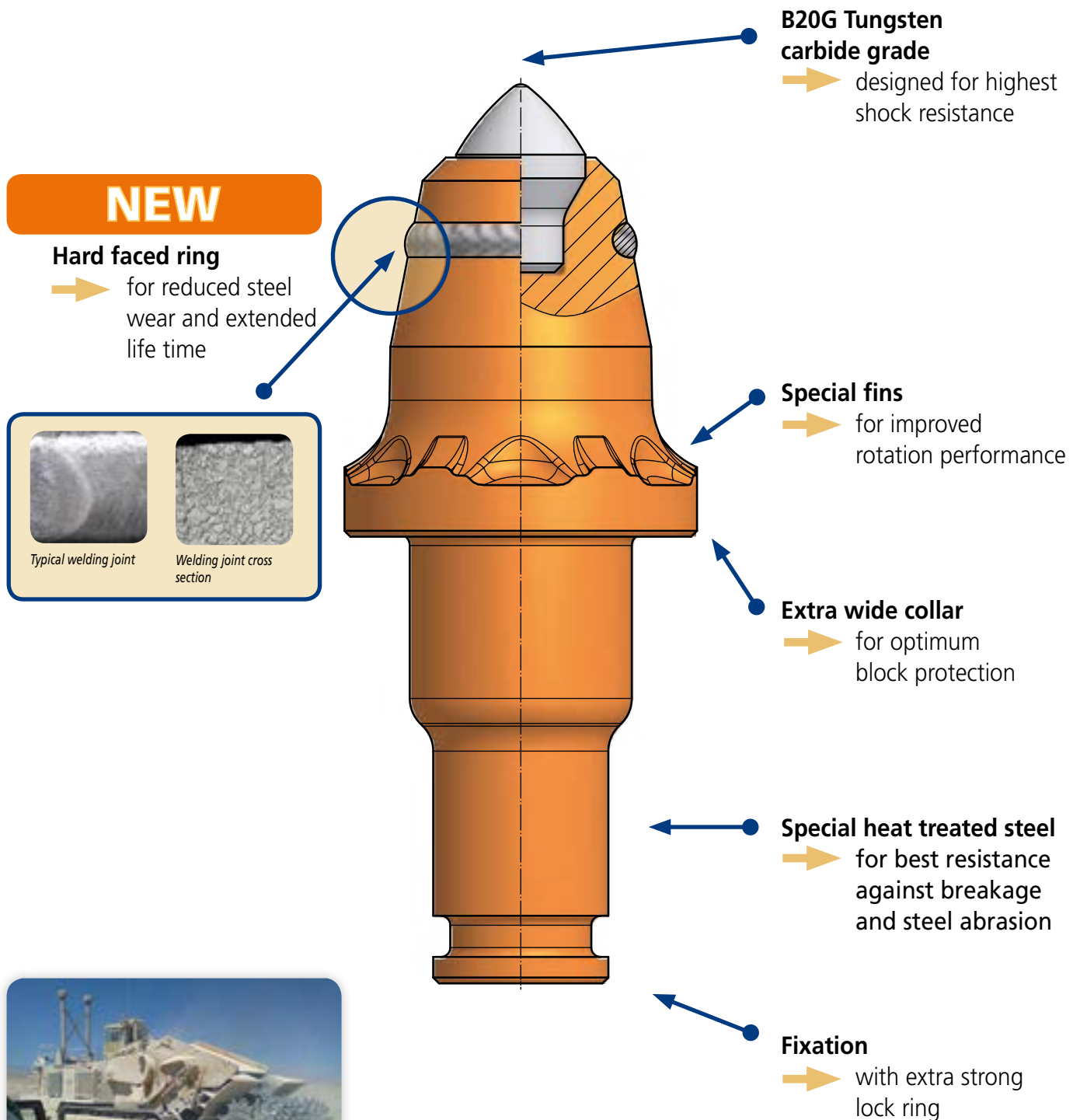

Shank system Ø 38/30 mm - 1,5/1,18" Gauge 64 mm/2,5"

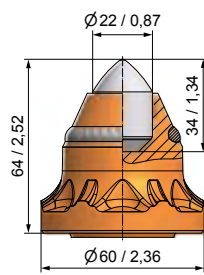
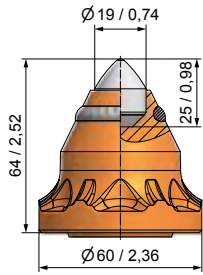
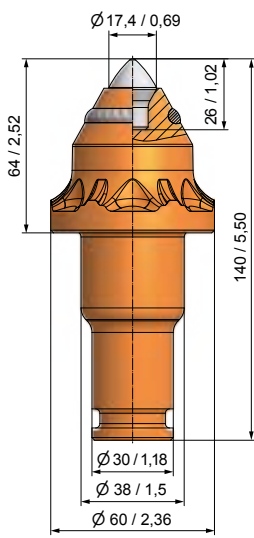

BKF22P 10
BS38F-19.6064P

BKF26P 10
BS38F-22.6064P

BZ35
Assembly tool

BZ34
Disassembly tool

BKF25P 10
BS38F-70.6064P

Shank system Ø 38/30 mm - 1,5/1,18" Gauge 77 mm/3,0"

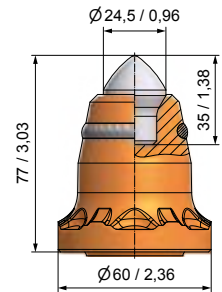
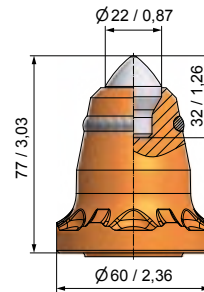
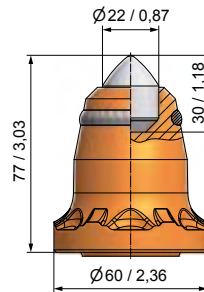
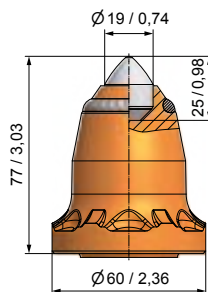
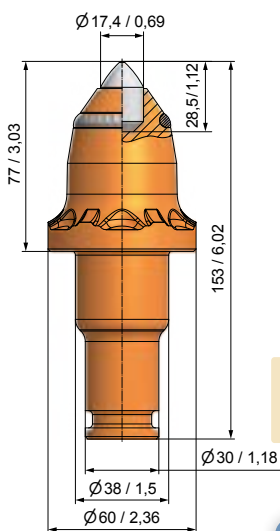

BKF30P 10
BS38F-19.6077P

BKF31P 10
BS38F-22.6077P

BKF38P 10
BS38F-73.6077P

BKF36P 10
BS38F-71.6077P

BKF33P 10
BS38F-17.6077P





US

GB

BETEK GmbH & Co. KG

Sulgener Str. 21 - 23
D-78733 Aichhalden
Germany

Service hotline + 49 (0) 74 22 / 5 65-590
Service fax line + 49 (0) 74 22 / 5 65-181

trenchtek@betek.de
www.betek.de



Sales partner

