

Foundation Drilling

*Tools for
true heroes!*



MADE IN GERMANY

BETEK

Progress!

In use worldwide: BETEK tungsten carbide tools



1 - Road milling



2 - Surface mining



3 - Stabilising



4 - Recycling



5 - Foundation drilling



6 - Crushing and mixing



7 - Horizontal directional drilling HDD



8 - Mining



9 - Trenching



10 - Tunnelling



11 - Hydraulic milling cutters



12 - Forest mulching



13 - Agriculture



14 - Rail track construction



15 - TungStuds

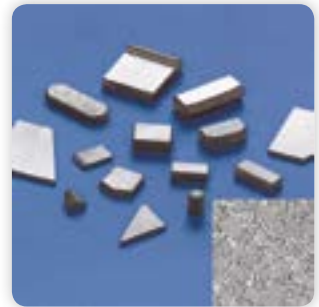

16 - Abrasive wear protection

Use innovative tool systems from BETEK – and you'll make good progress with above-average daily productivity! The contours of BETEK tools and the grade of tungsten carbide used are always tailored to the job at hand. This ensures a long service life and minimal tool changes.

Progress well with wear-resistant grades of tungsten carbide

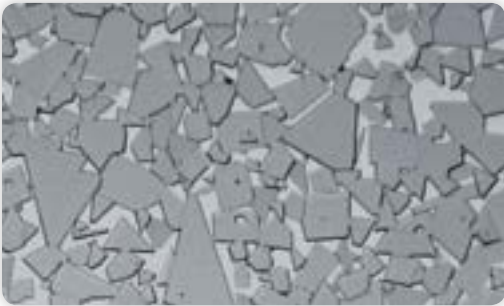

Cross-section through grade B20G tungsten carbide, as used, for example, for foundation drilling

Tungsten carbide and steel – firmly bonded for extreme demands

Steel and carbide are two materials with totally different expansion coefficients when subjected to heat. Nevertheless, it is of steel and tungsten carbide that our tools are made, with tungsten carbide for the wear-resistant tip, and steel for the tool shank. Since tools reach high temperatures during use, extreme tensile stresses are generated. These stresses are absorbed by a special brazing material that joins the tungsten carbide tip to the steel section.

We have developed our own methods and systems for this brazing process, which is carried out on fully automated machines with the process covered in an inert protective gas. Manufacturing parameters are fully monitored and documented to ensure consistent quality. Afterwards, brazing shear strengths are checked to ensure that our “Masters of the construction site” lose no time due to broken tools!



Monitored manufacturing on the fully automated soldering machine



The soldering process to permanently bond tungsten carbide and steel

How our high-tech tools are made

- Cost-effective client solutions based on flexible structures
- Tailored, fast response to client requirements

Customer service

- Speedy creation of samples and prototypes
- Competitive prices thanks to close collaboration with all areas of production

Development & design

- Raw materials of high purity used for great strength
- Consistently high, pore-free tungsten carbide quality produced through an exact process resulting from years of experience and know-how

Tungsten carbide manufacturing

Production equipment and processes specially developed to the utmost degree of perfection by experts in combining tungsten carbide and steel

The soldering side of production

Able to compete on the world market by virtue of a high degree of automation and flexible manufacturing plants

Automation

Permanent checking of quality in accordance with DIN ISO 9001:2000 and DIN EN ISO 14001 along the entire production chain all the way to the construction site

Quality assurance

User training sessions at Betek or on the construction site itself to ensure long-term economic success and client satisfaction

Training

Able to react quickly thanks to:

- The use of cutting edge IT and optimum logistics links
- Standard products kept in store

Logistics



Tool range

Page

Welding bars		6 – 8
Quick change bars		9 – 12
Weld-on teeth		13 – 14
Dragon Tooth		15
Flat teeth		16 – 19
Pilots		20
Round shank cutter bits	Shank system Ø 11,3 mm/0,44", 13 mm/0,52"	21
Round shank cutter bits	Shank system Ø 14 mm/0,55", 18,7mm/0,74"	22
Round shank cutter bits	Shank system Ø 19,4 mm/0,76"	23
Round shank cutter bits	Shank system Ø 25 mm/1"	24 – 25
Round shank cutter bits	Shank system Ø 38/30 mm - 1,5/1,18"	26 – 27
Screw connections		28 – 29
Flat teeth for Hydro Cutter		30
Wear Protection		31

Below the pictures of tools on the following pages you will find the following information:

→ **Art-No**
→ Description



← Packaging unit

Dimensions: mm / inches

Welding instructions see:

www.betek.de/en/productprogramme/foundation-drilling-userinfo.html



SUPPORT:

Germany: info@betek.de
Tel.: +49 (0) 74 22 / 5 65-591

Welding bars

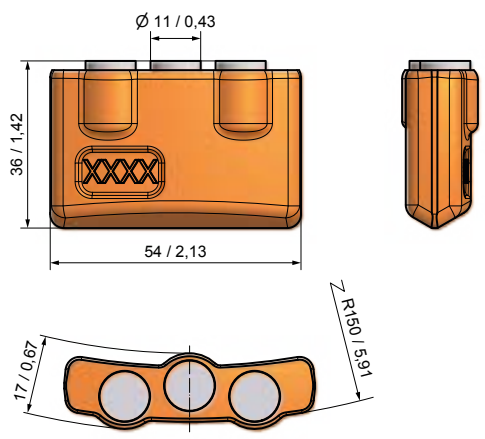

BA12
BA55-17/11/R 50

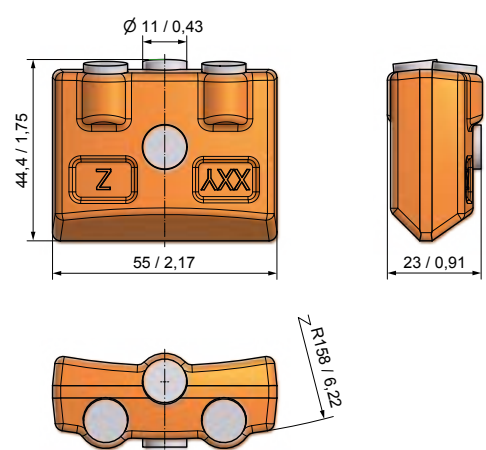

BA13
BA55-22 50

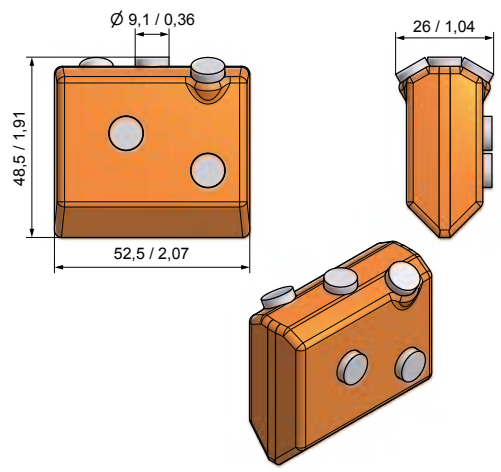

BA10
BA50-26.5 50

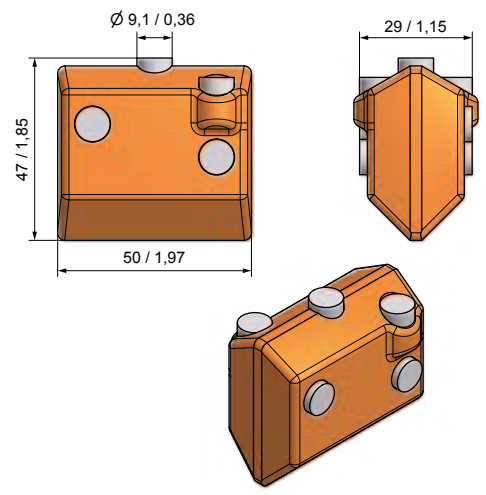

BA09
BA50-29 30

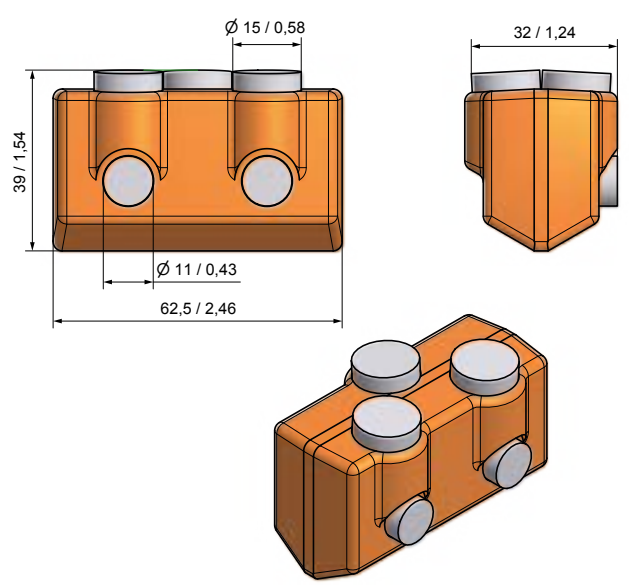

BA32
BA60-32/2 25

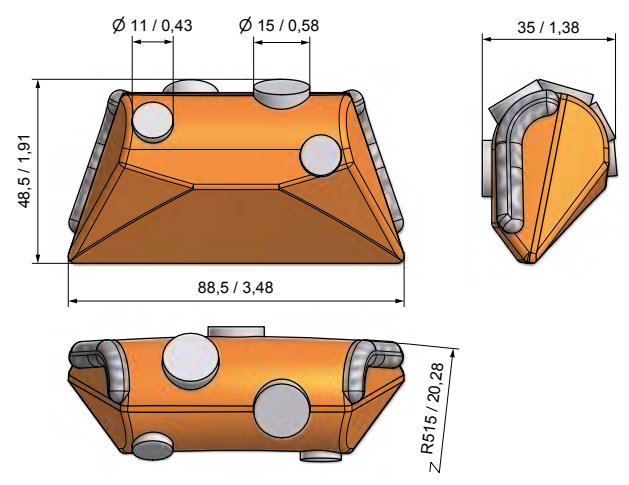

BA01
BA90-35 25

Welding bars

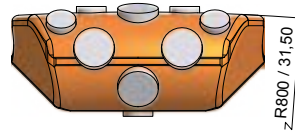
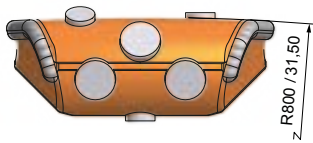
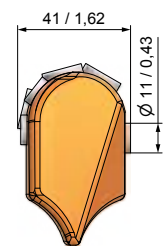
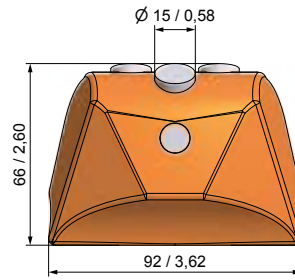
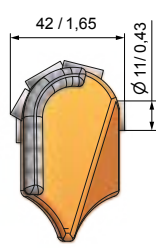
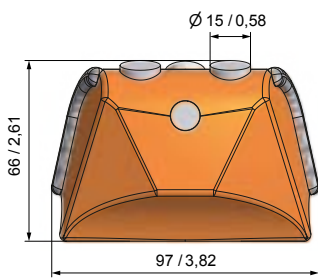

BA24
BA90-42

15

BA62
BA92-41

15

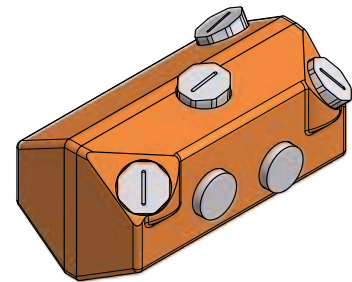
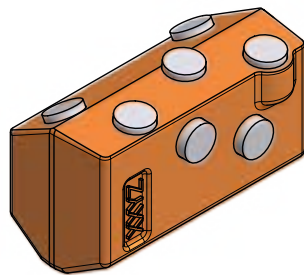
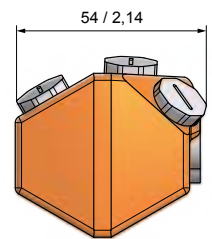
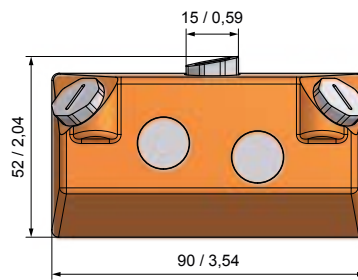
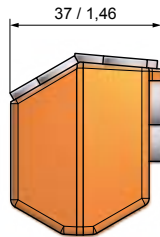
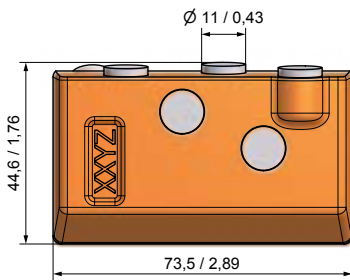

BA04
BA70-38

20

BA19
BA90-54

10



Welding bars

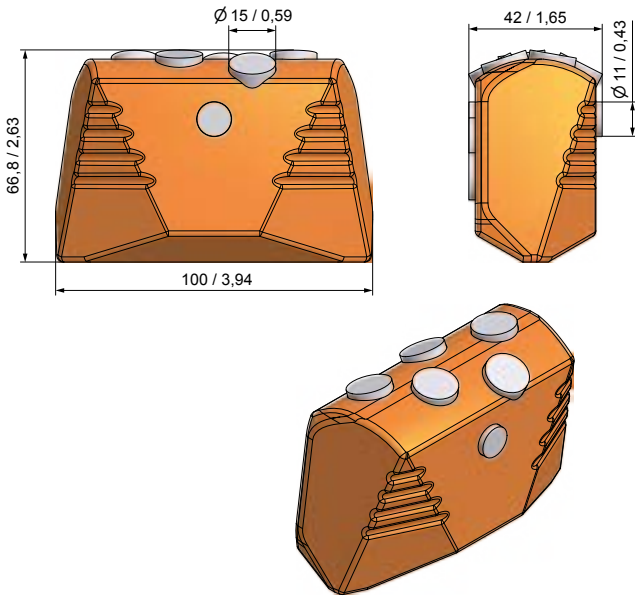

BA55
BA100-42

10

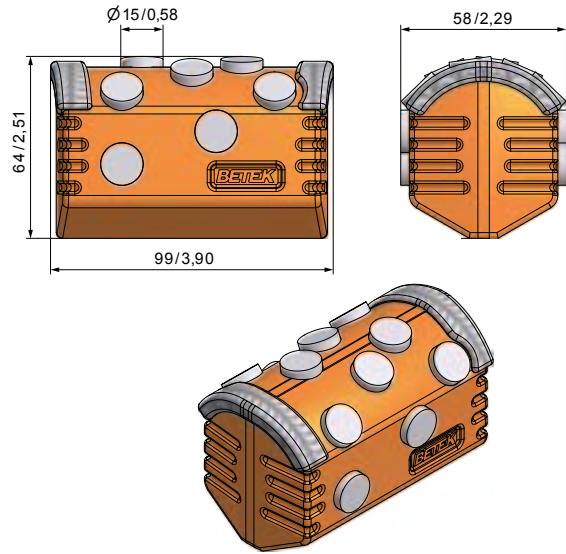

BA28
BA90-58/3

8

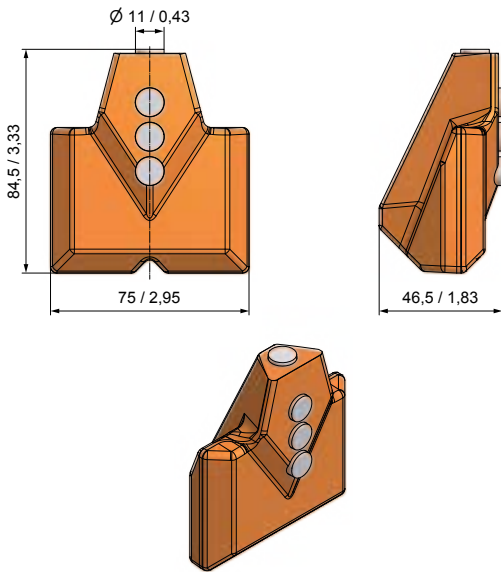

BFZ26
BFZ83x75x45 / 1

15

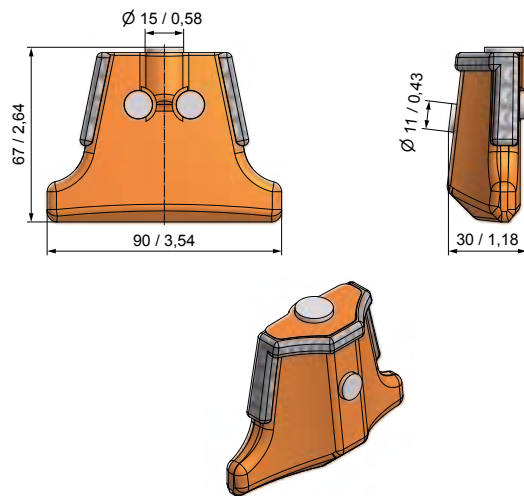

BFZ72 / B
BFZ65x90x30

25



Quick change bars 30 mm/1,18" casing wall thickness

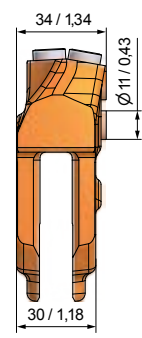
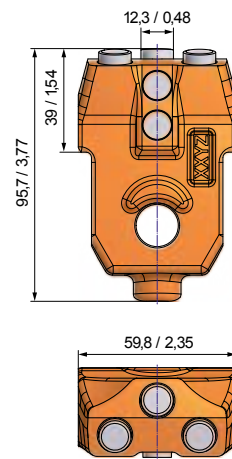
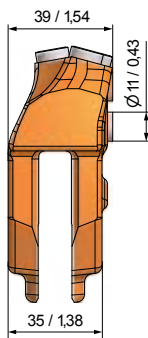
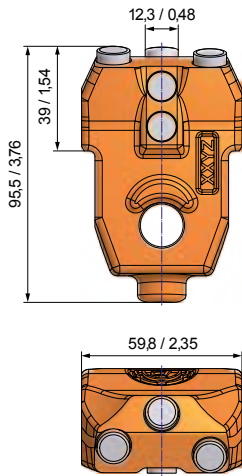

BA58
BA96x60x35



BA60
BA96x60x30

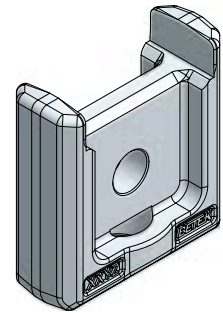
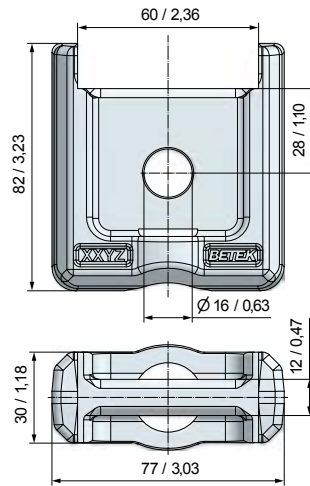
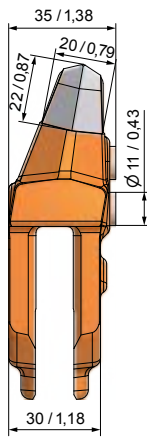
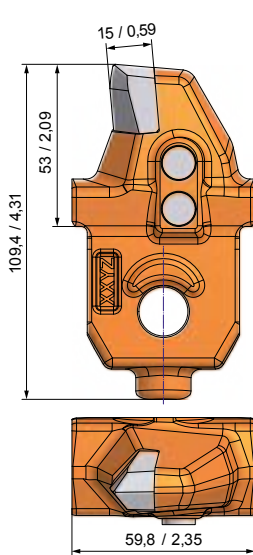

BA61
BA109x60x30



BHA06
BHA77x82x30

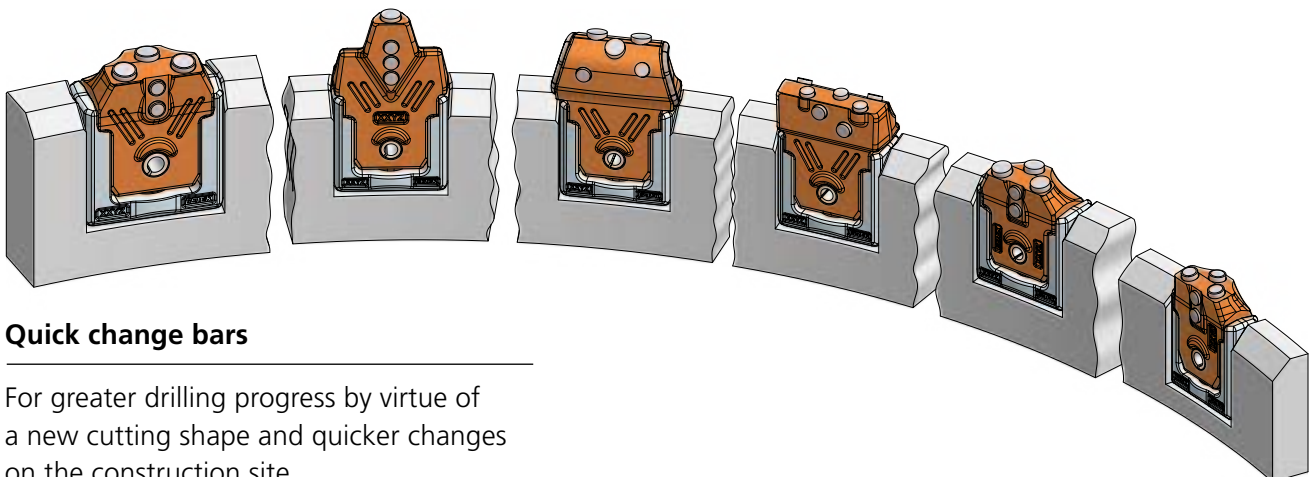

Quick change bars

For greater drilling progress by virtue of a new cutting shape and quicker changes on the construction site.

Quick change bars 40 mm / 1,58" casing wall thickness

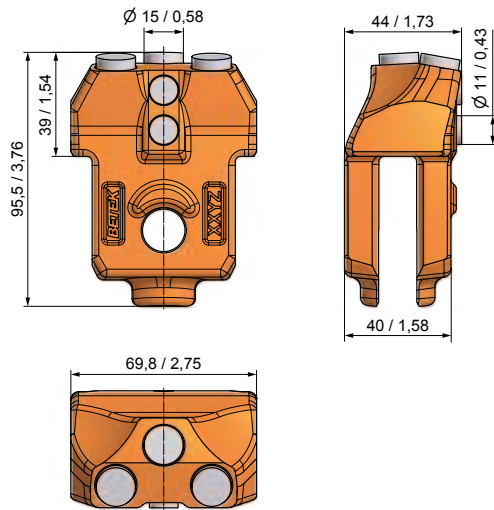

BA47
BA96x70x40

10

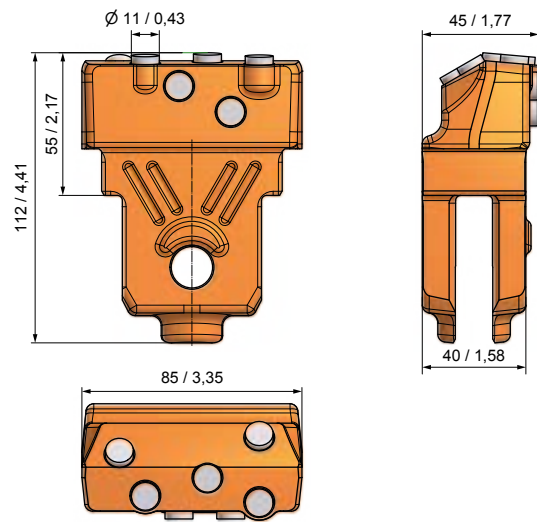

BA50
BA112x85x40

10

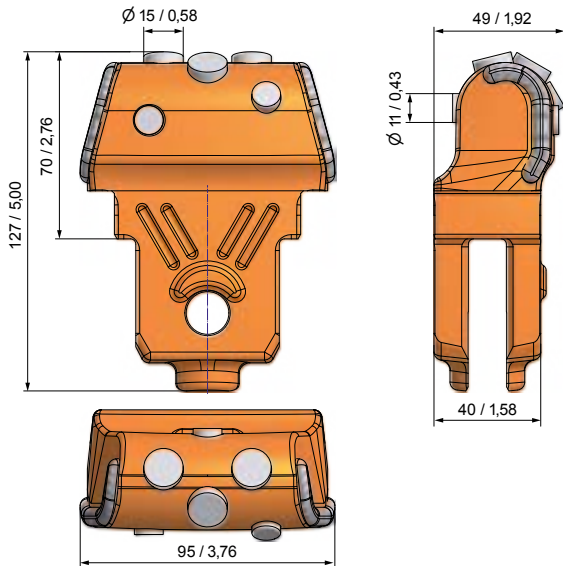

BA51
BA127x90x40

8

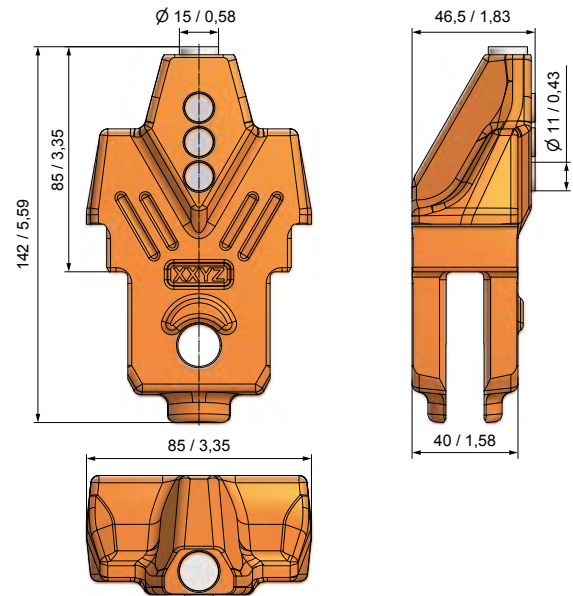

BA52
BA142x85x40

10

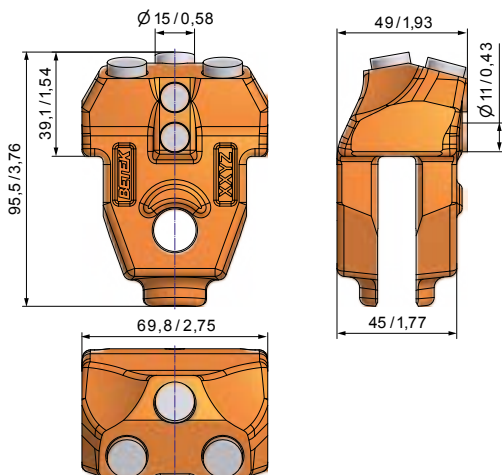

BA57
BA96x70x45

10

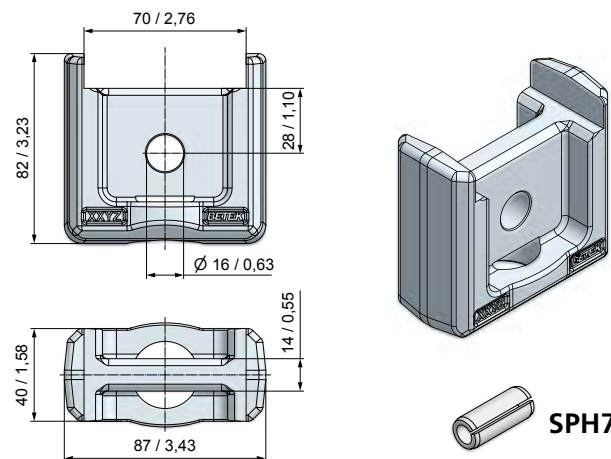

BHA04
BHA87x82x40

10

SPH73

Quick change bars 40 mm/1,58" casing wall thickness

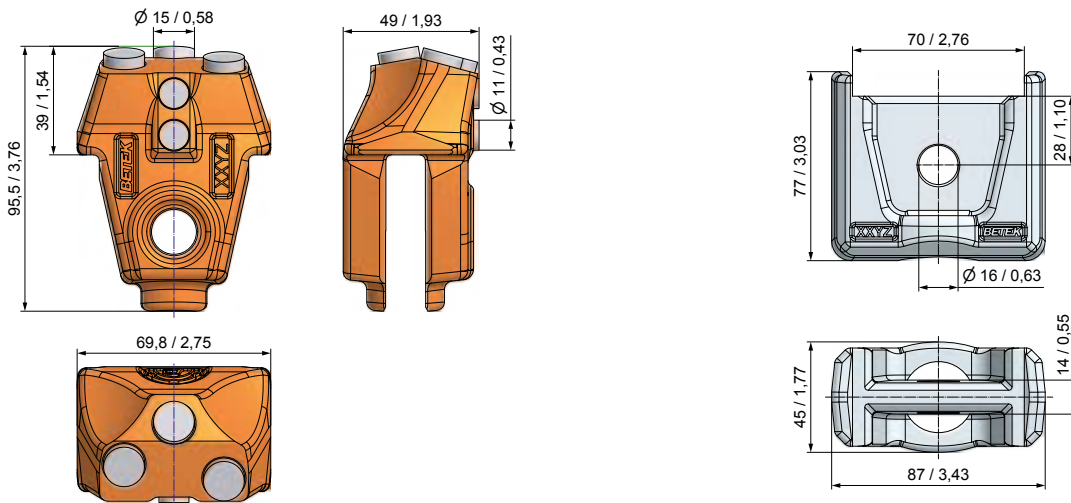

BA63
BA96x70x45



BHA07
BHA87x77x40



Quick change bars 50 mm/1,97" casing wall thickness

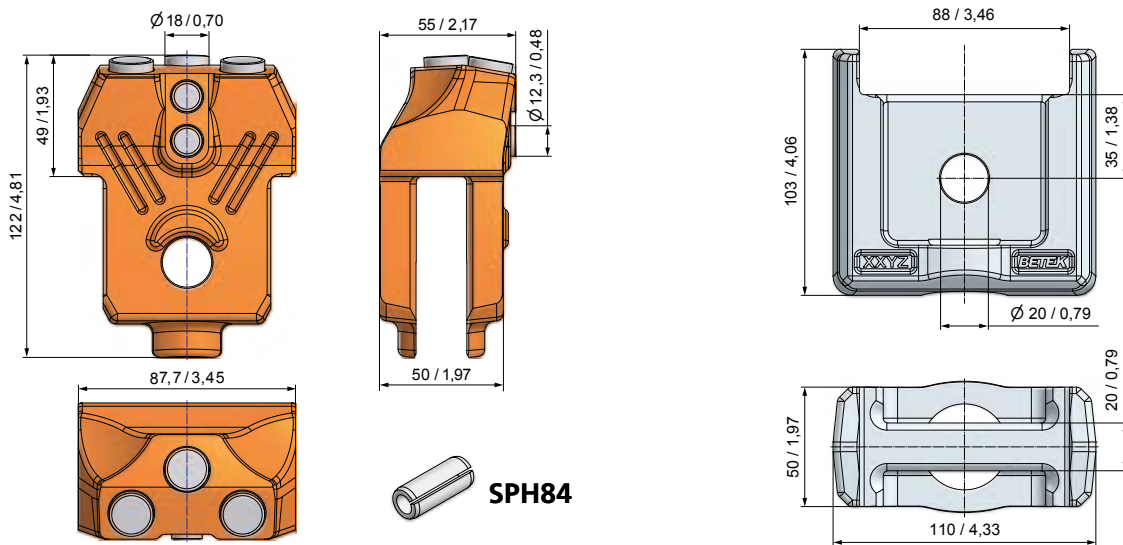

BA53
BA122x88x50



BHA05
BHA110x103x50



Bore protection on augers

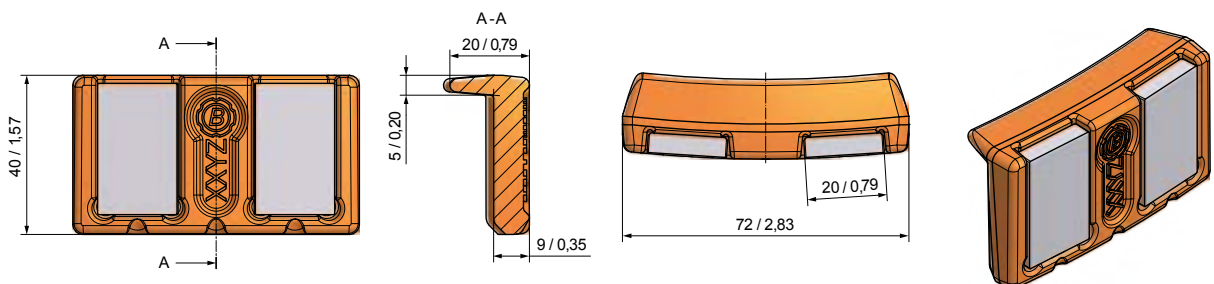

BA54
BA72x40x20



Quick change bars 40 mm / 1,58" casing wall thickness

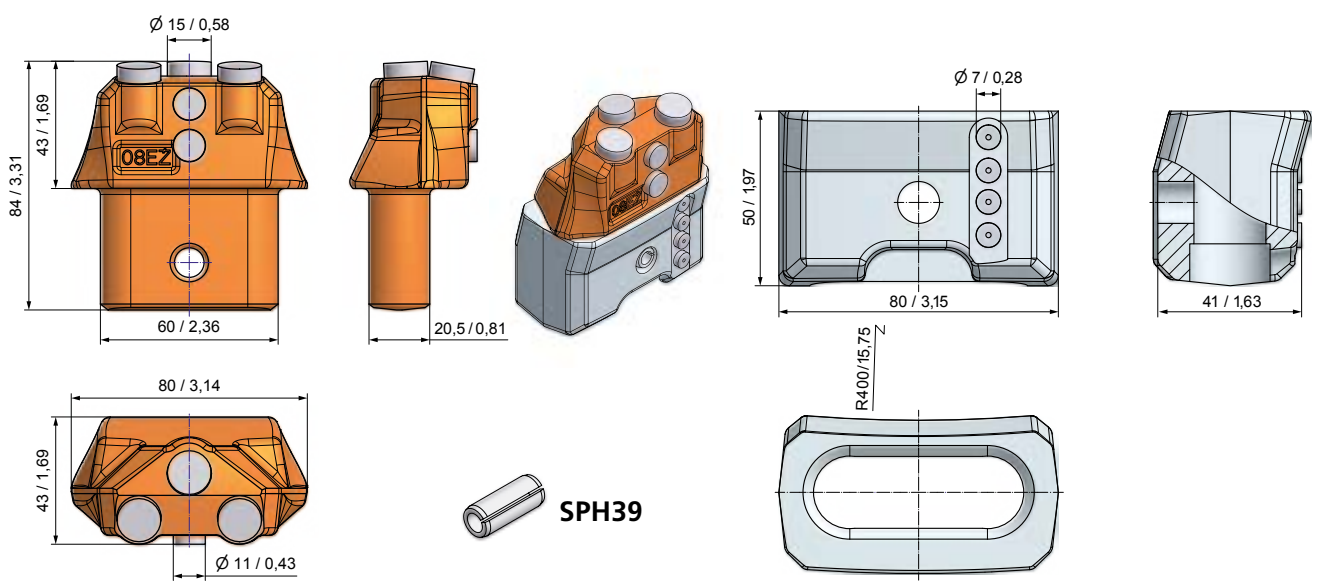

BA46
BA80-31 15

BHA02
BHA60/2 20

Weld-on teeth

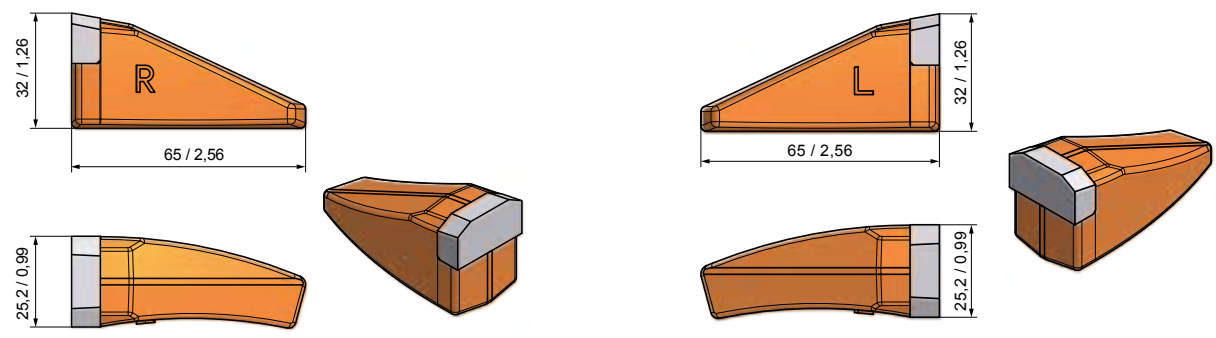

BFZ25R
BFZ25-R 50

BFZ25L
BFZ25-L 50

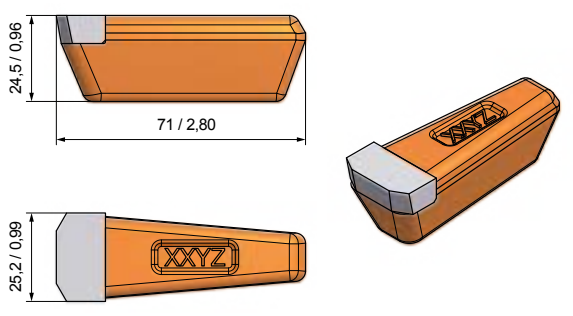

BFZ96
BFZ71x25 50



Weld-on teeth

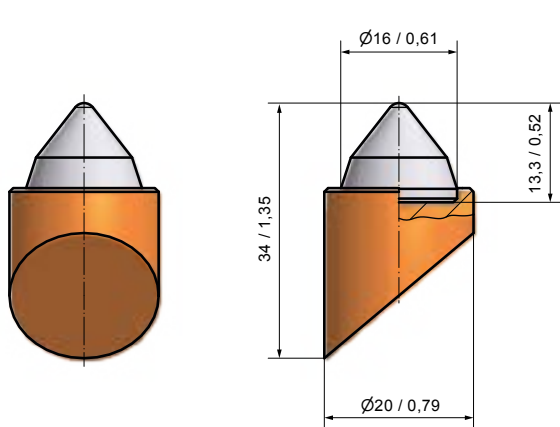

BFZ158
BFZ3 250

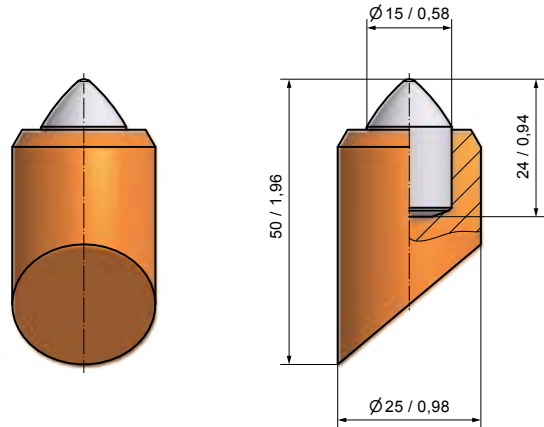

BFZ207
BFZ1 100

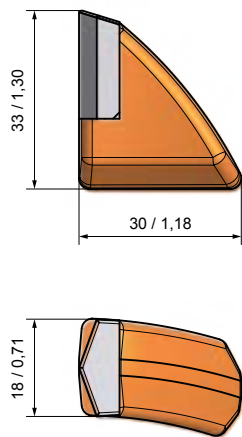

BFZ107
BFZ18/R 200

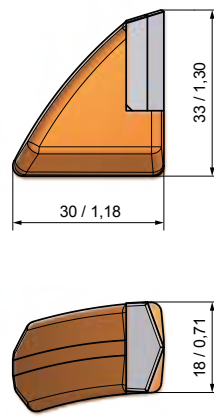

BFZ144
BFZ18/L 200

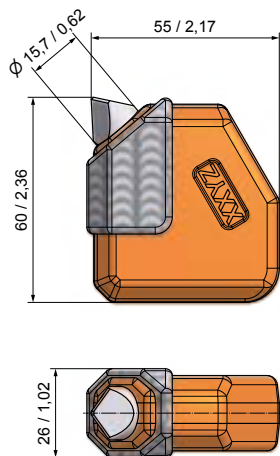

BFZ257
BFZ60x55x22 25

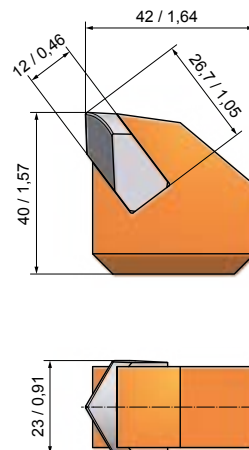

BFZ260
BFZ42x40x23 50

Weld-on teeth

BFZ87
BFZ18/2

50

BFZ319
BFZ75x65x20

25

BFZ318
BFZ46x44x13

100

BFZ321
BFZ32x27x13

100

BFZ320
BFZ44x39x22

50

BFZ326
BFZ38/M

25

Dragon Tooth

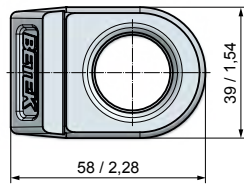
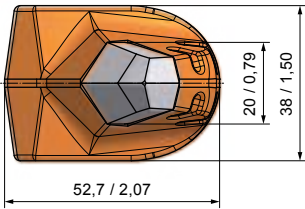
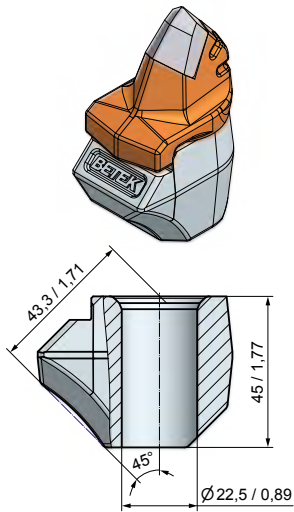
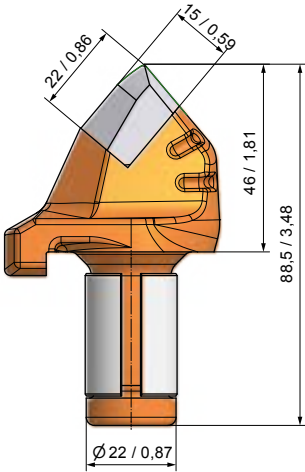
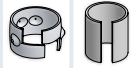

BFR07

40

BFR46-22

BHR133

40

B10/22-F

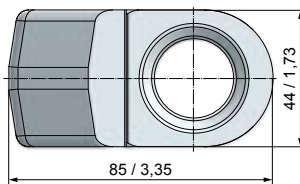
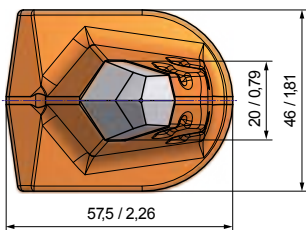
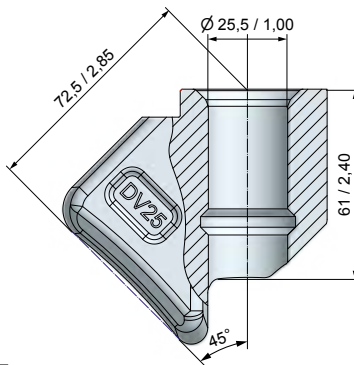
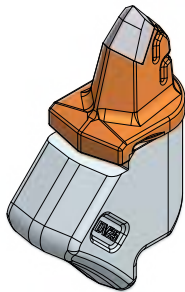
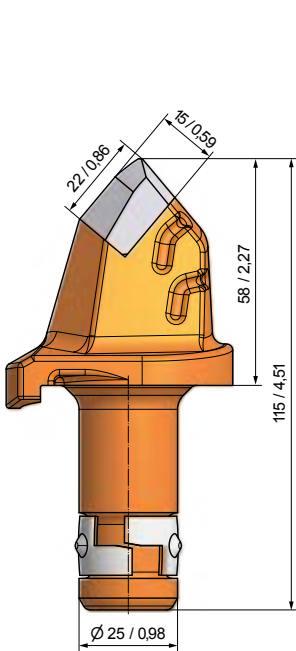

BFR08

25

BFR58-25

BHR184

15

DV25-F

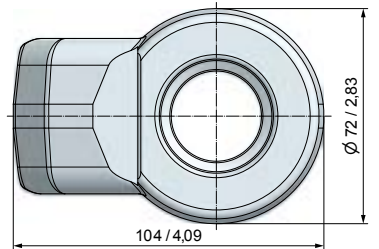
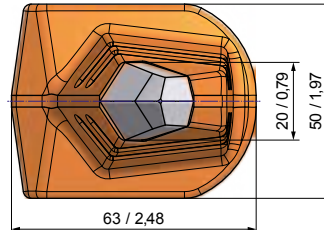
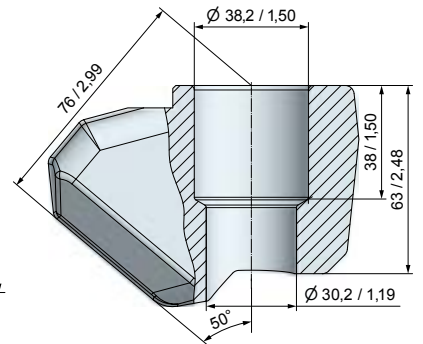
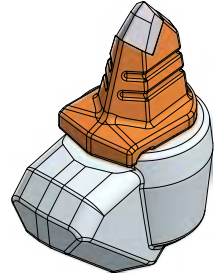
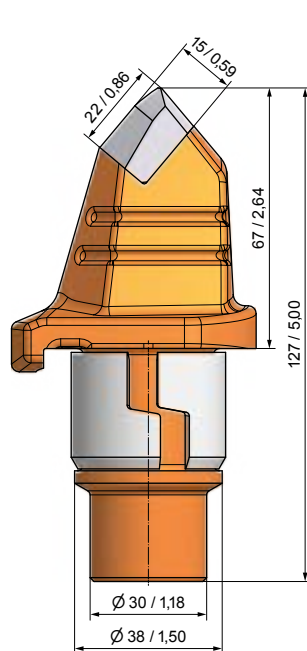

BFR10

15

BFR67-38/30

BHR244

15

B43K-F

Flat teeth

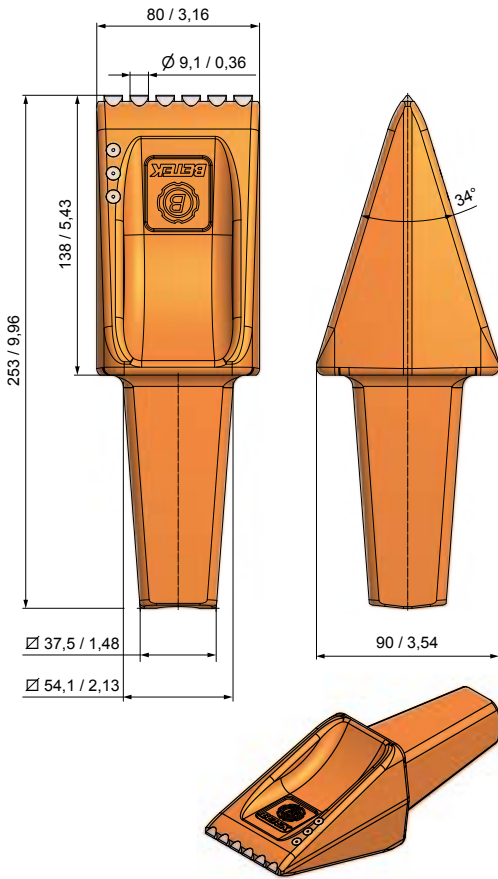

BFZ317
BFZ80-B

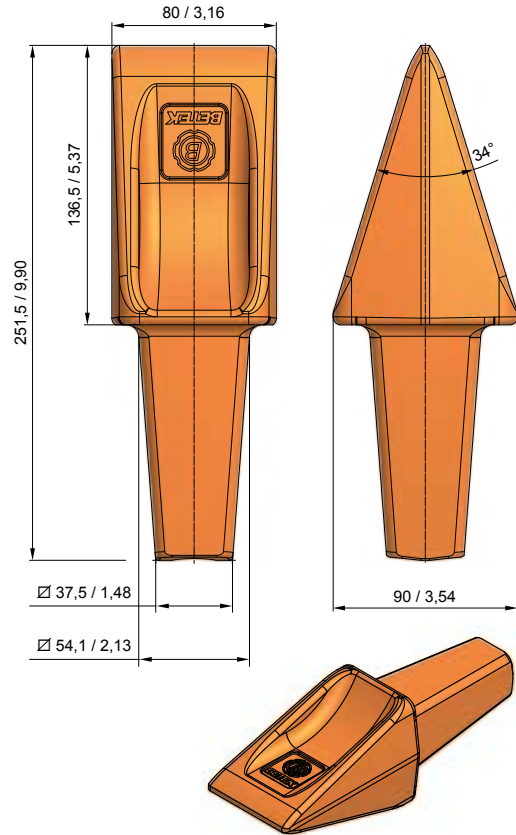

BFZ79
BFZ80OHM

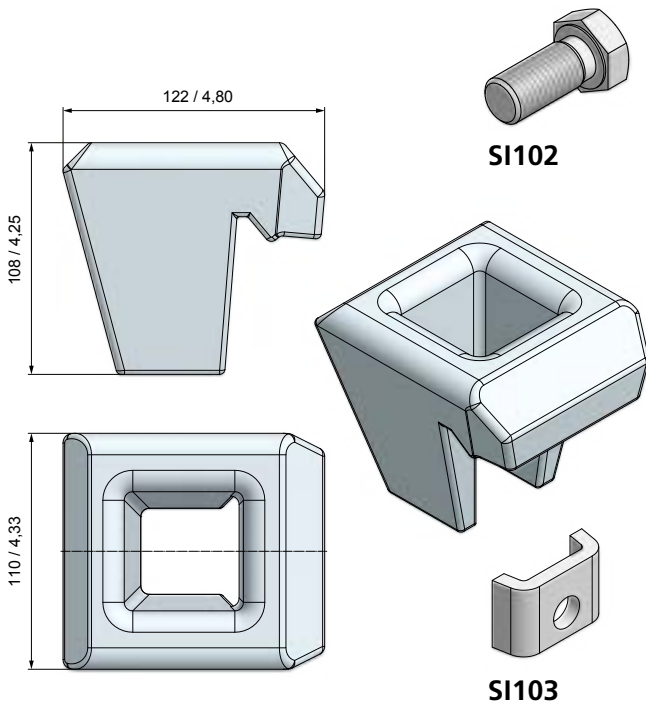

BHR73
BHZ80/2



Flat teeth

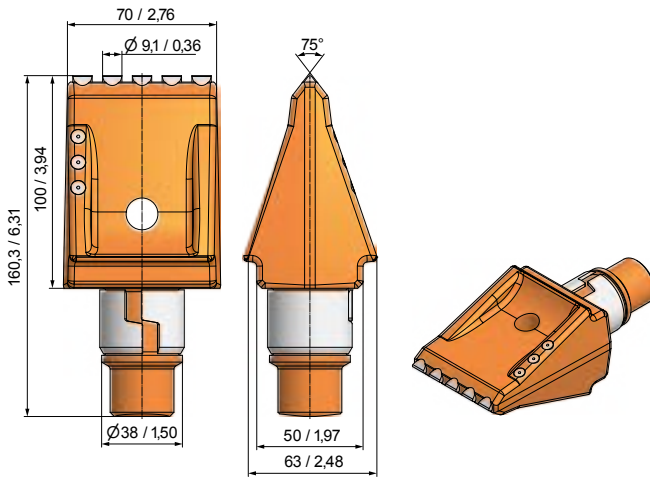

BFZ162
BFZ100x70/2 5

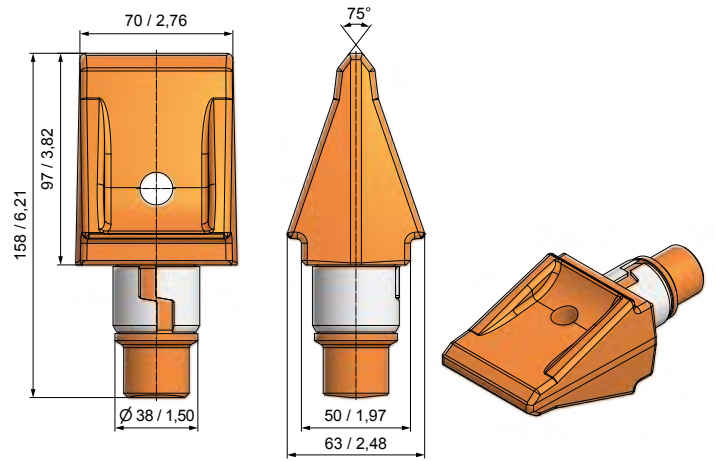

BFZ69
BFZ100x70 5

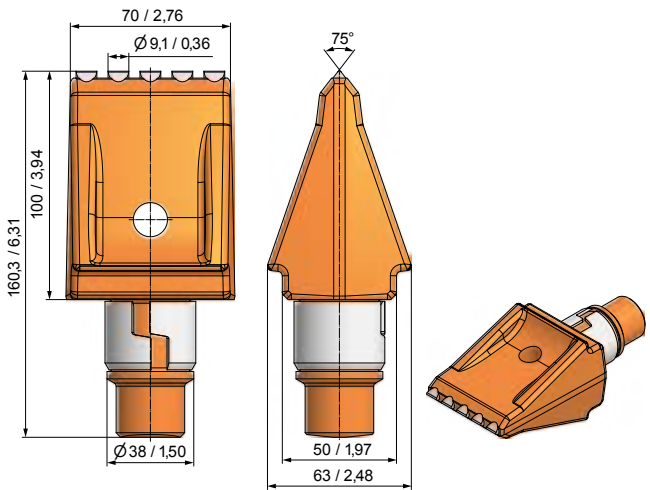

BFZ339
BFZ100x70/4 5

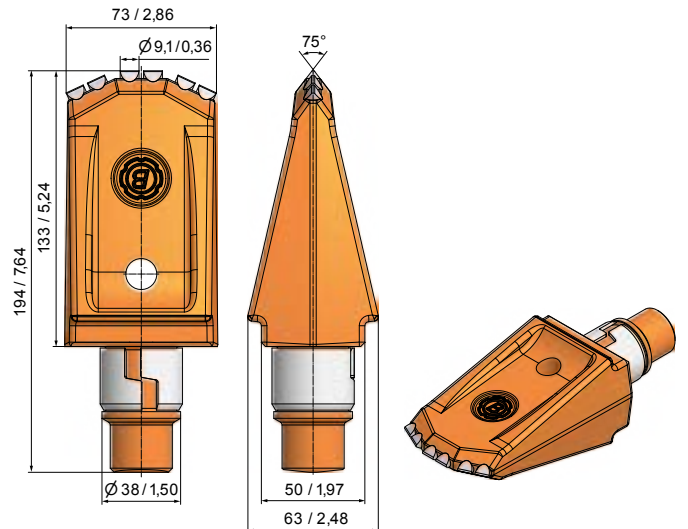

BFZ322
BFZ133x73/HM 4

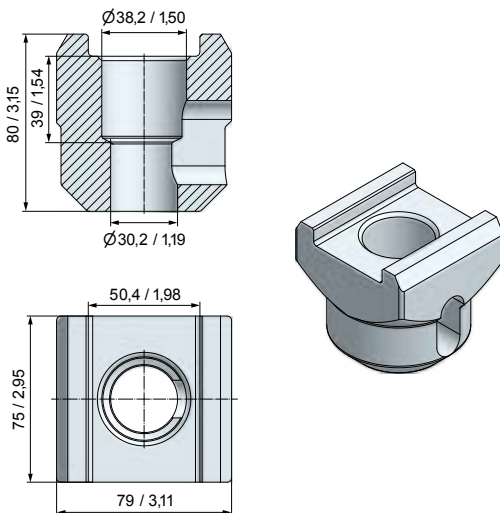

BHR112
B75 5

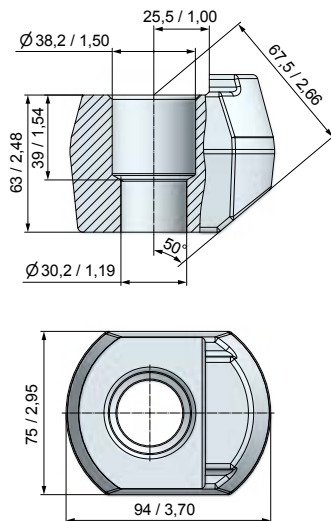

BHR39
B48 6

Flat teeth

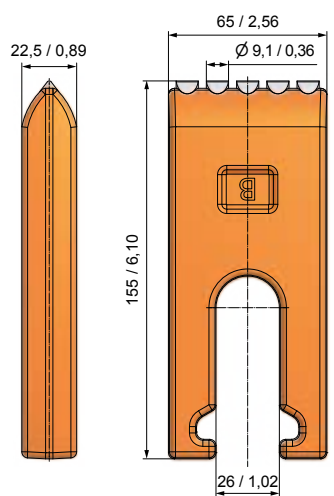

BFZ65HM
BFZ65/2

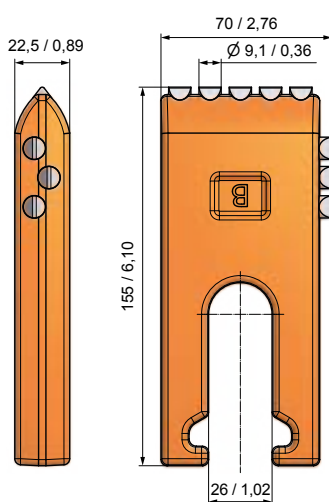

BFZ02
BFZ65/3

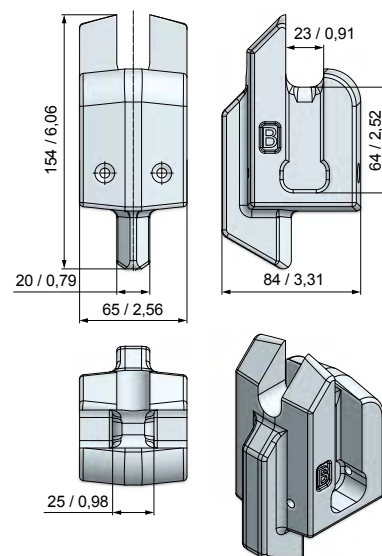

BHF02
B65-22

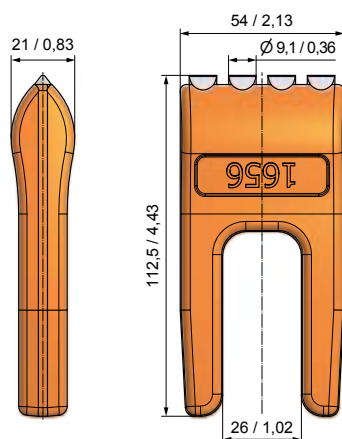

BFZ05N
BFZ1656N

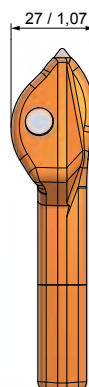

BFZ198N
BFZ1658N

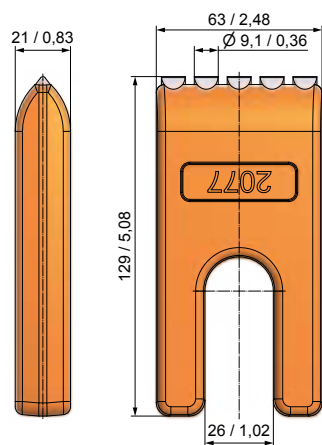

BFZ200N
BFZ2077N

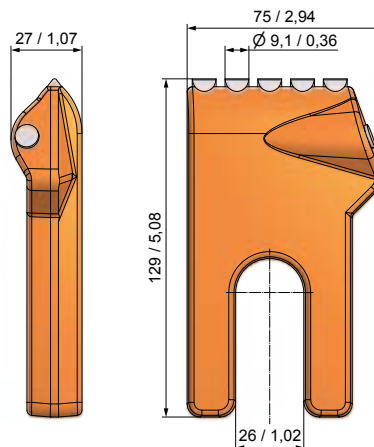

BFZ218
BFZ2078



Flat teeth

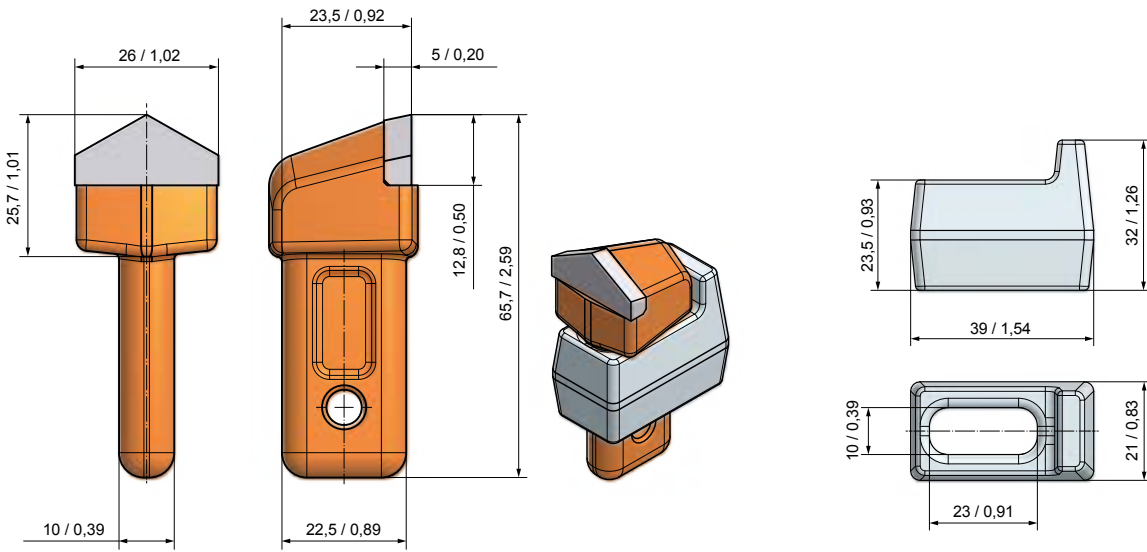

BFZ272
BFZ67x30x26 100

BHZ24
BHZ39x32x21 100

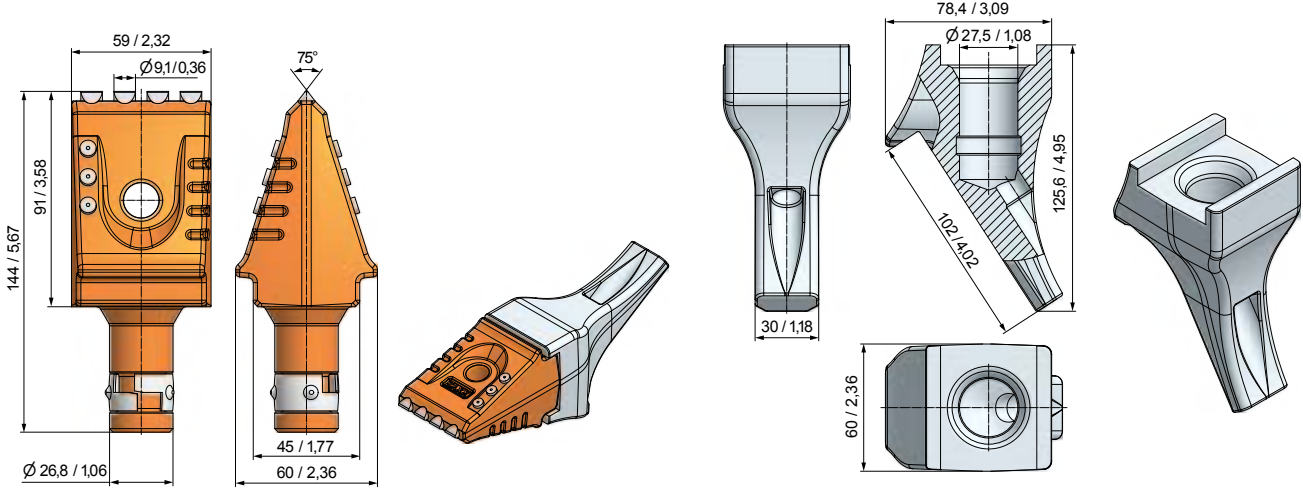

BFZ324
BFZ91x59 10

BHR220
B27.60 10



Pilots

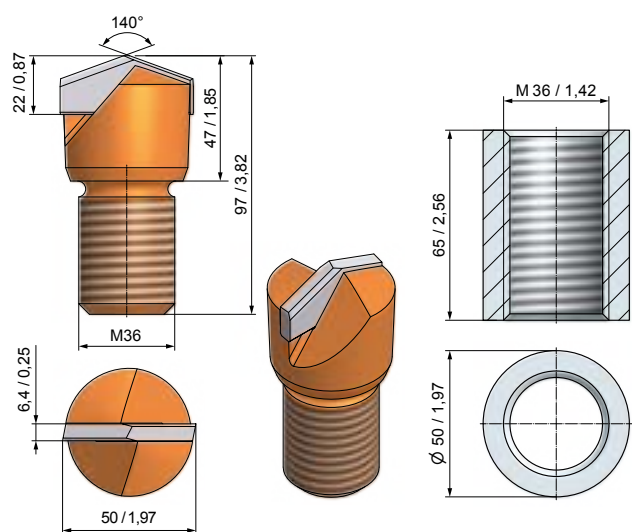

BP04
BP51/M36-HD3

20

BPH01
GH-M36

20

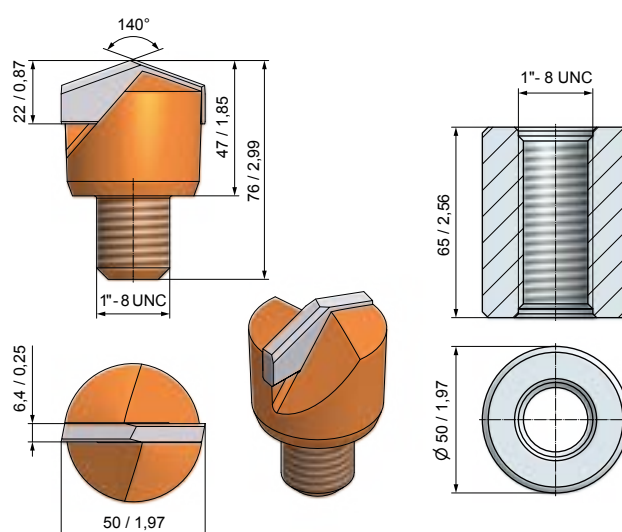

BP01
BP51/1"-HD3

20

BPH02
GH-1"

20

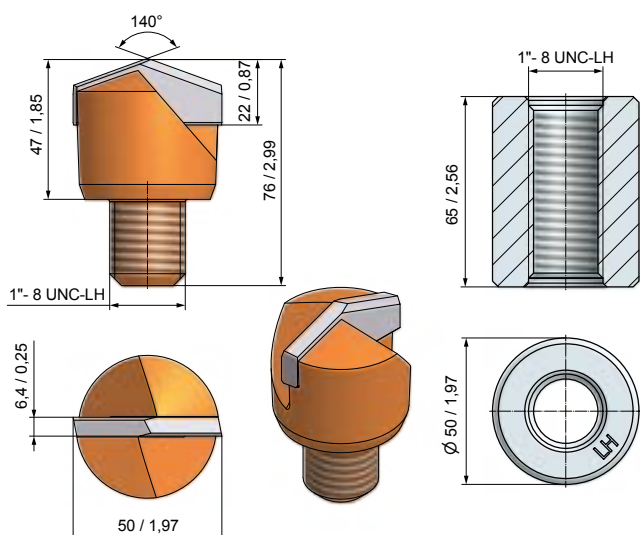

BP10
BP51/1"-HD3/LH

20

BPH03
GH-1"LH

20

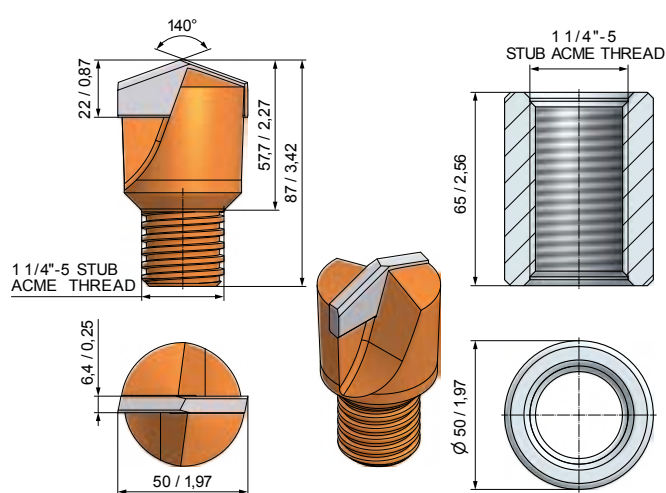

BP51
BP51x87

20

BPH04
GH-1 1/4"-5

20



Shank system Ø 11,3 mm/0,44"

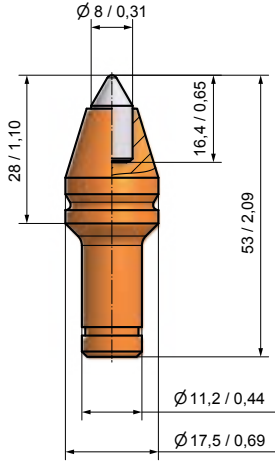

BM11

200

BM8-11.3

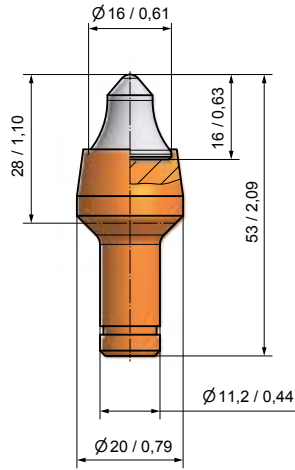

BM10

200

BM4-11.3

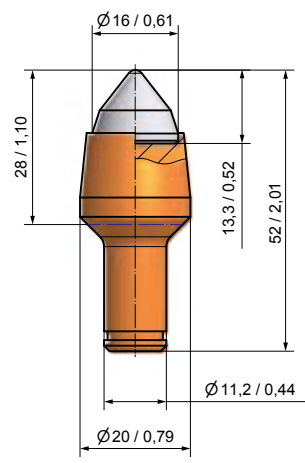

BM46

200

BM3-11.3

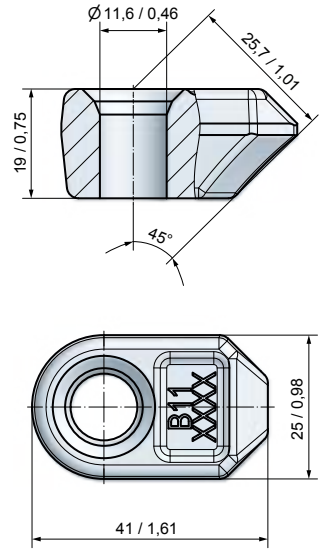

BHR03

200

B11

Shank system Ø 13 mm/0,52"

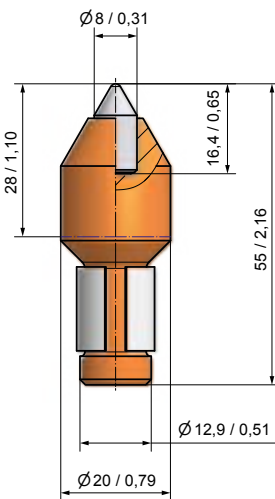

BM34

200

BM8-13/H

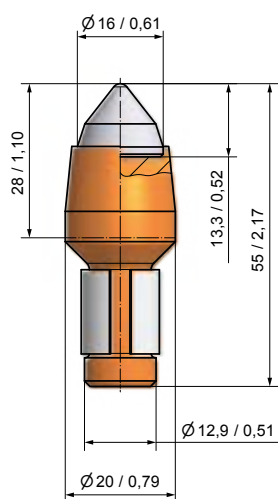

BM62

200

BM3-13/H

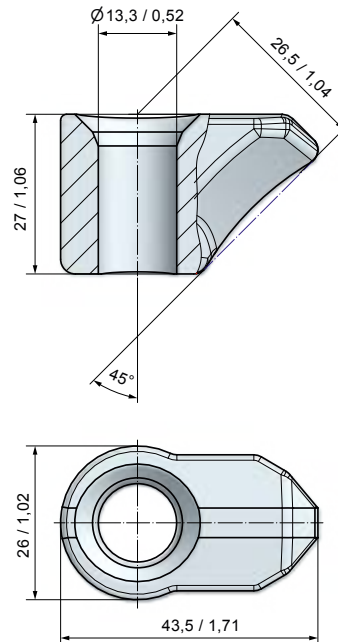

BHR47

150

B13

Shank system Ø 14 mm/0,55"

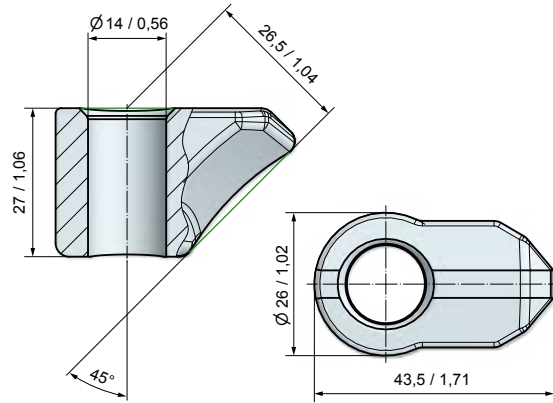
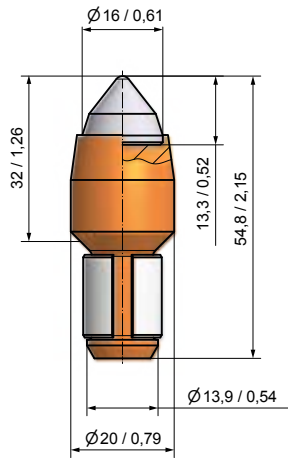
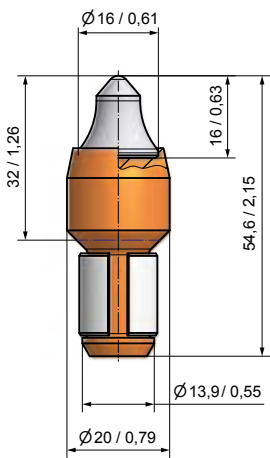

BM55

200

BM4-14/2

BM60

200

BM3-14/H

BHR109

150

B14

Shank system Ø 18,7 mm/0,74"

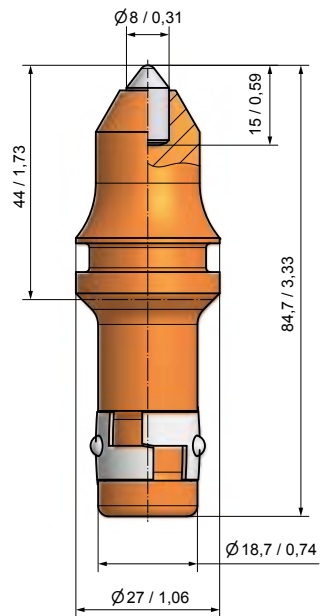
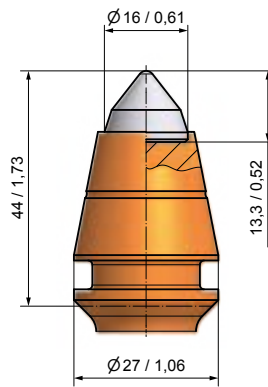
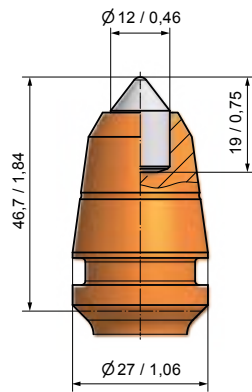
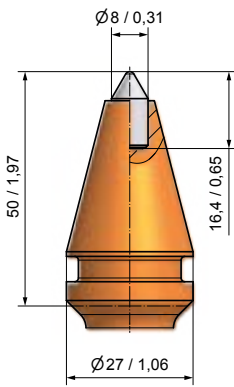

BTR08

75

B43K8S

BTR02

50

B43HDK12

BTR03

50

B43/3

BTR01

50

B43K8

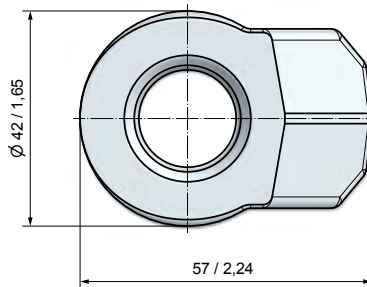
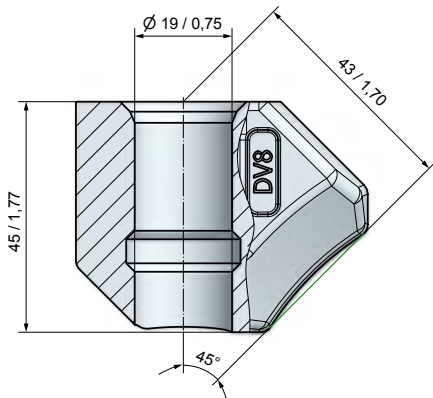

BHR20

40

DV8

Shank system Ø 19,4 mm/0,76"

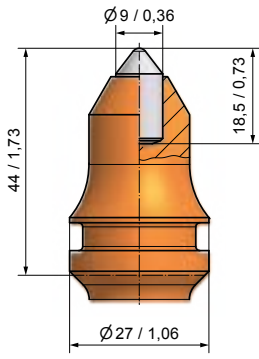
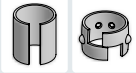

BSK15
B1K9-K

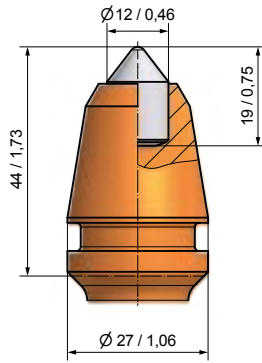

BSK17
B1HDK12-K

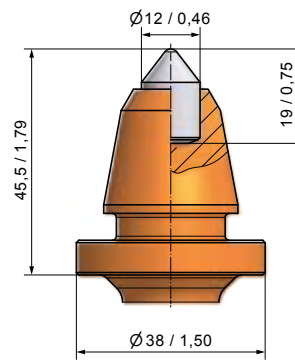

BSK21
B1-12/38-K

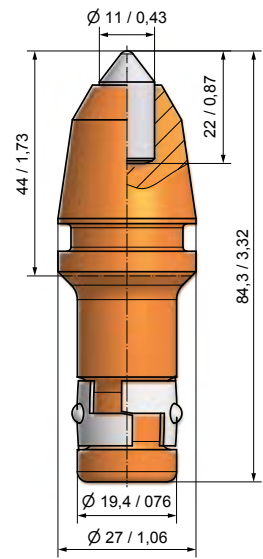

BSK16
B1HDK11-K

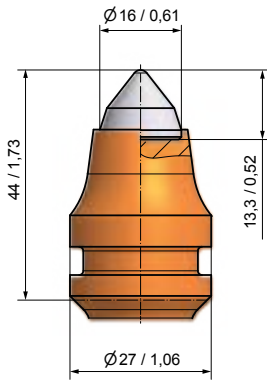

BSK12
B3-K

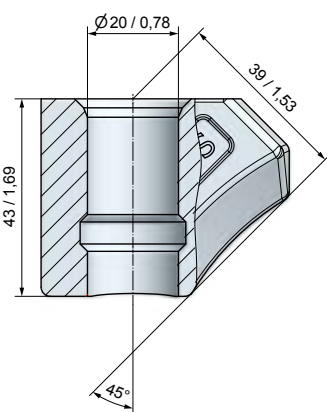

BHR164
DV9-S

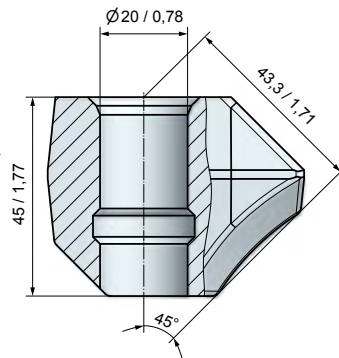

BHR07
DV9

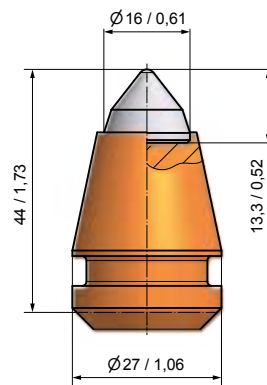

BSH09
B3

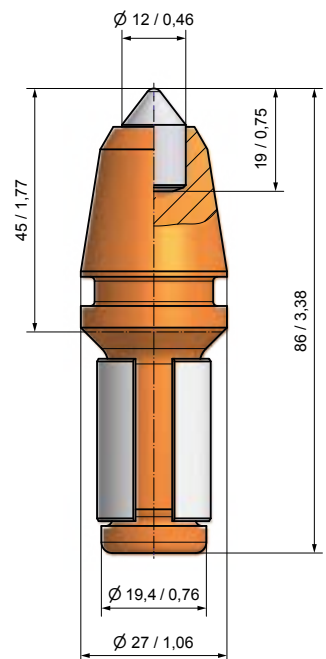

BSH05
B1HDK12



Shank system Ø 25 mm / 1"

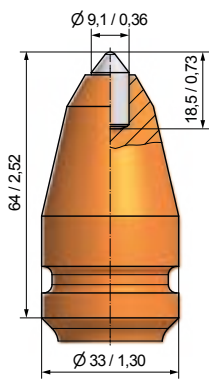

BTK01
B40K9

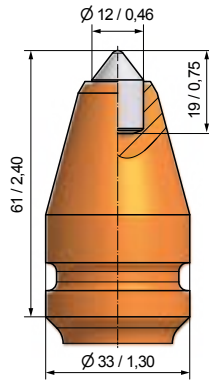

BTK03
B40HDK12

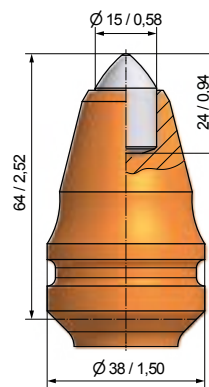

BTK10
B40HDS

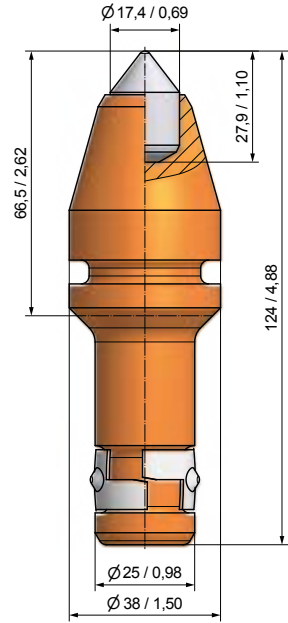

BTK70
B40K17.5

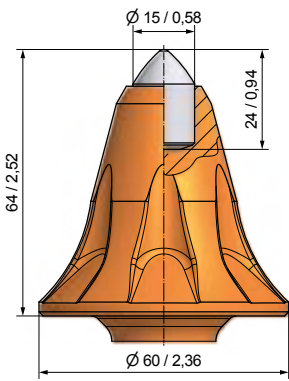

BTK81
B40HDS/60

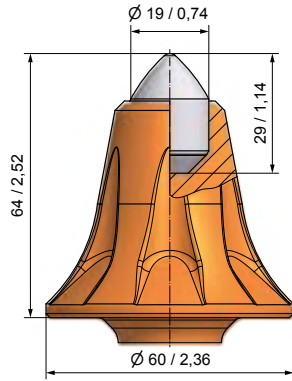

BTK89
BG25K-19.6064

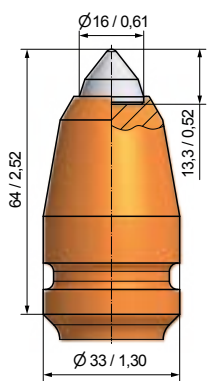

BTK16
B40/3

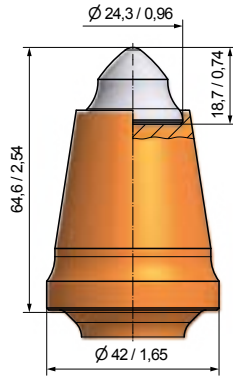

BTK87
B40/9

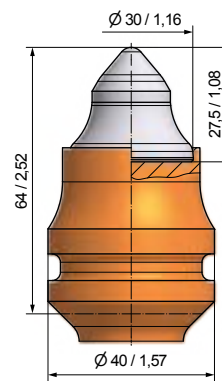

BTK23
B40HBL

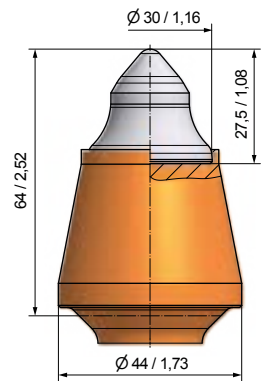

BTK26
B40-J1-HBL



Shank system Ø 25 mm/1"

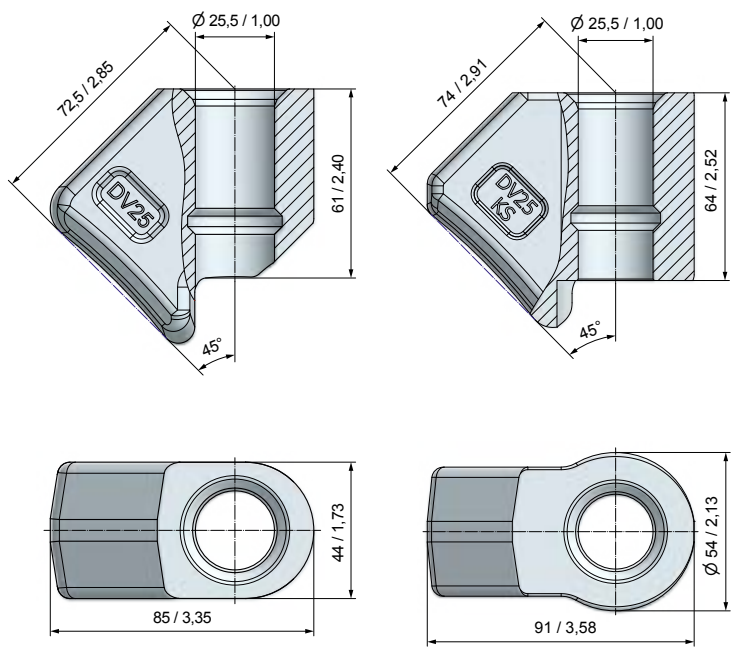

BHR31
DV25

15

BHR121
DV25KS

10

BZ22
Bit puller



Shank system Ø 38/30 mm - 1,5/1,18"

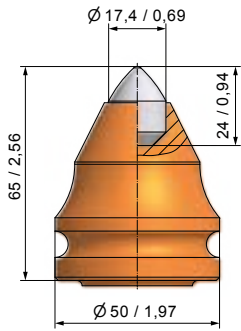

BKH140 15
B47K17.5-H/2

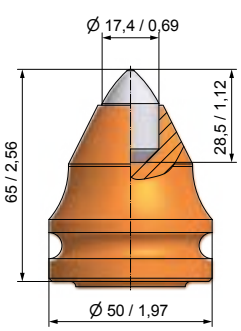

BKH28 15
B47K17.5-H

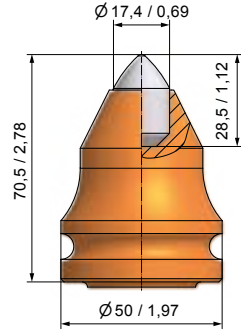

BKH80 15
B47K17.5LK70-H

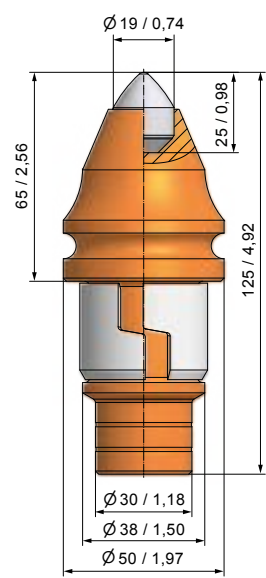

BKH83 15
B47K19-H/2

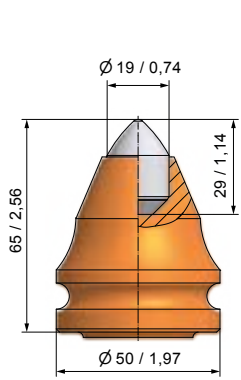

BKH40 15
B47K19-H

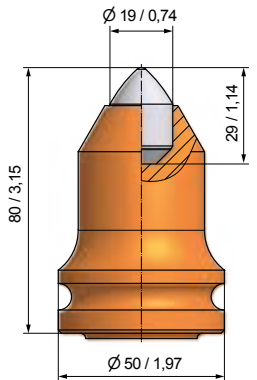

BKH41 15
B47K19LK80-H

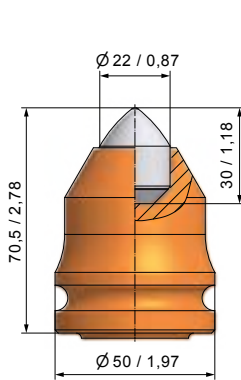

BKH85 15
B47K22-H/2

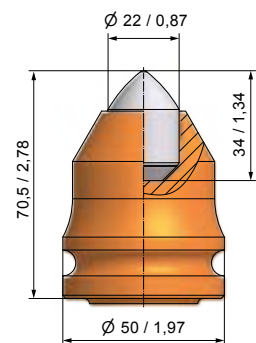

BKH47 15
B47K22-H

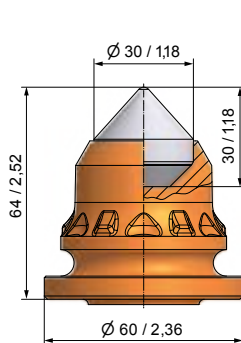

BKH92 10
BS38H-30.6064

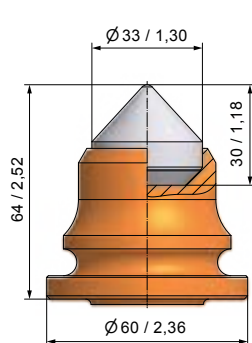

BKH84 10
B47K33/60-H

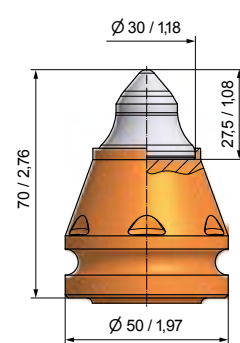

BKH101 15
BS38H-69.5070

Shank system Ø 38/30 mm - 1,5/1,18"

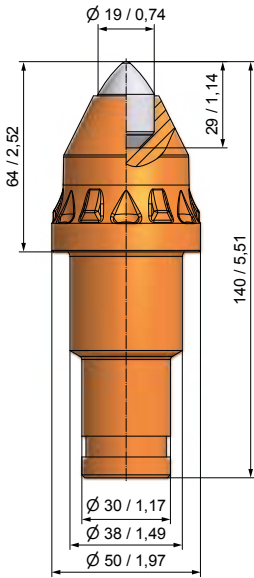

BKS154 10
BS38W-19.5064

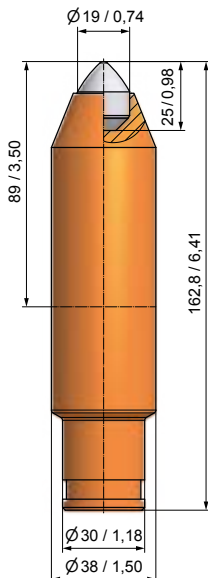

BKS186 15
BS38W-19.3889

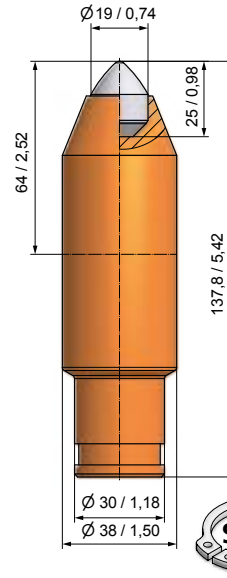

BKS187 15
BS38W-19.3864

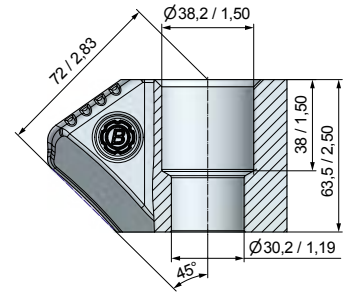

BHR38 10
B43H

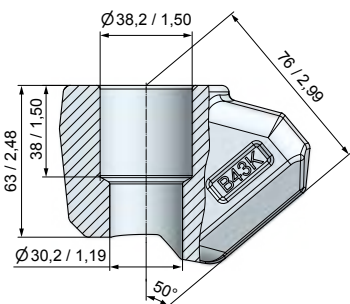
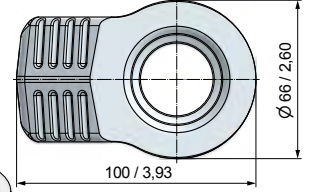

BHR113 6
B43K

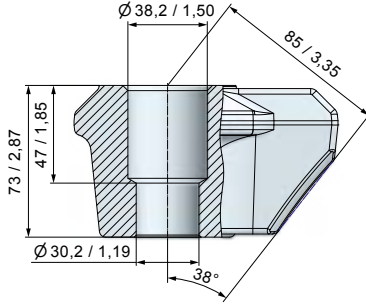

BHR77 5
B320

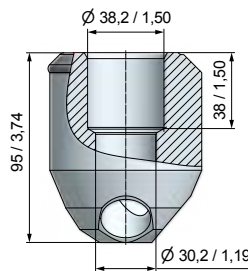

BHR163 6
B76/P

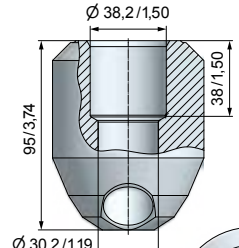
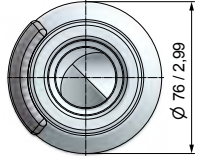
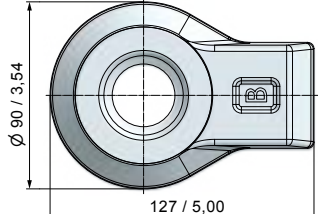
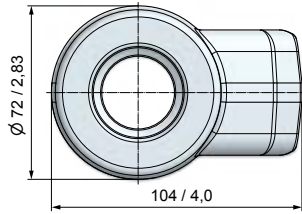
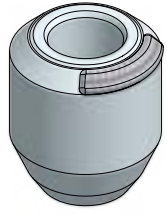

BHR216 6
B76

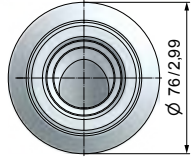
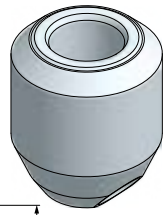

BZ12
Bit puller



BZ18
Bit puller
incl. copper disc

Screw connections

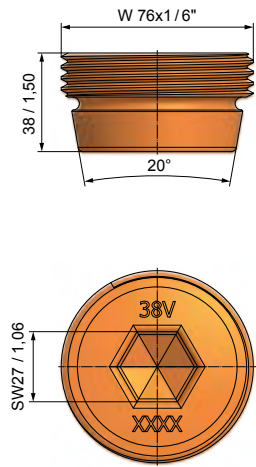

BRV08
BRV75/38LV

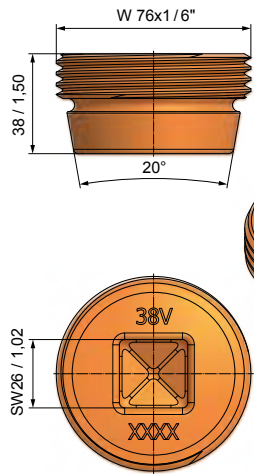

BRV10
BRV75/38LV/4

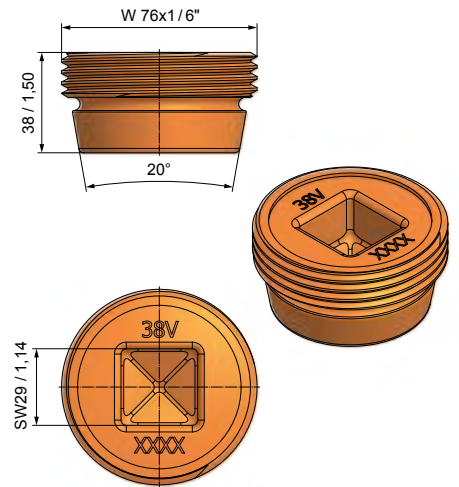

BRV23
BRV75/38LV/4/29

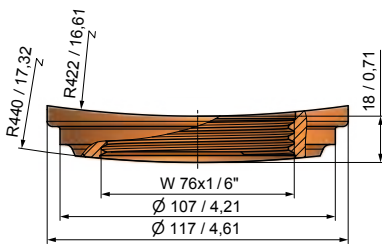

BRV02
BRV-G88/L

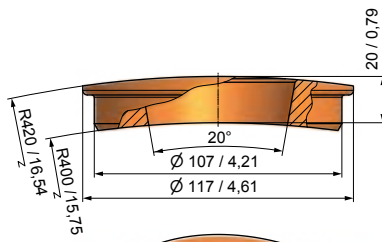

BRV03
BRV-K88/L

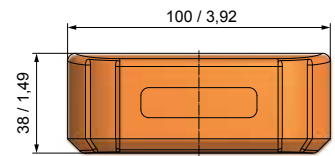

BRV32
BRV-AK

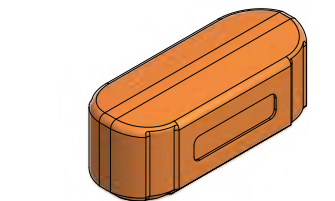

BRV34
BRVSW26

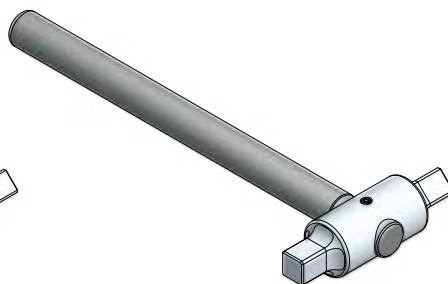
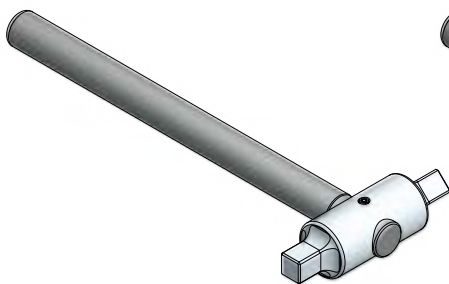

BRV35
BRVSW29

Description	Application / Info	Art-No
Casing screw connections for walls 30 mm thick		
BRV-G46-14	d=460	BRV19
BRV-K46-14	d=460	BRV18
BRV60/29/4	–	BRV20
Casing screw connections for walls 40 mm thick		
BRV-G64/B	d=620 - 640	BRV04
BRV-K64/B	d=620 - 640	BRV05
BRV-G64/L	d=620 - 640	BRV14
BRV-K64/L	d=620 - 640	BRV15
BRV-G88/L	d=880	BRV02
BRV-K88/L	d=880	BRV03
BRV-G118/L	d=1180	BRV06
BRV-K118/L	d=1180	BRV07
BRV-G150/L	d=1500 - 1800	BRV12
BRV-K150/L	d=1500 - 1800	BRV11
BRV-G80-100-B	d=800 - 1000	BRV30
BRV-K80-100-B	d=800 - 1000	BRV31
BRV75/38LV	(6kt.SW27)	BRV08
BRV75/38LV/4	(4kt.SW26)	BRV10
BRV75/37/12°/BV	–	BRV16
BRV75/38LV/4	(4kt.SW29)	BRV23
O-Ring 5x60	–	SI116
Casing screw connections for walls 50 mm thick		
BRV75/48/4	–	BRV17
BRV-G140-23	d=1400 - 1500	BRV21
BRV-K140-24,5	d=1400 - 1500	BRV22
Other		
BRV-AK	(Stop wedges)	BRV32

Flat teeth for Hydro Cutter

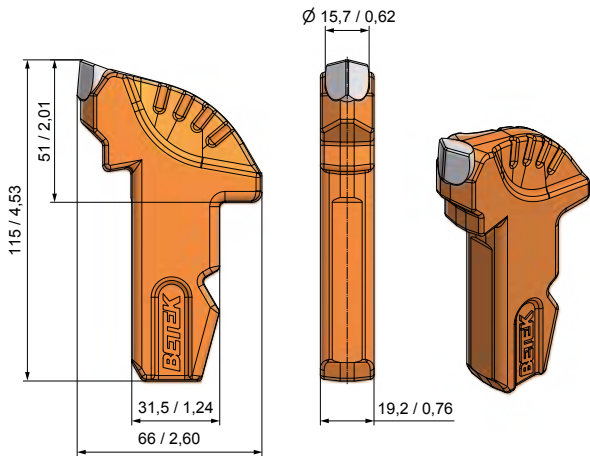

BF40

BF115x32x19

25

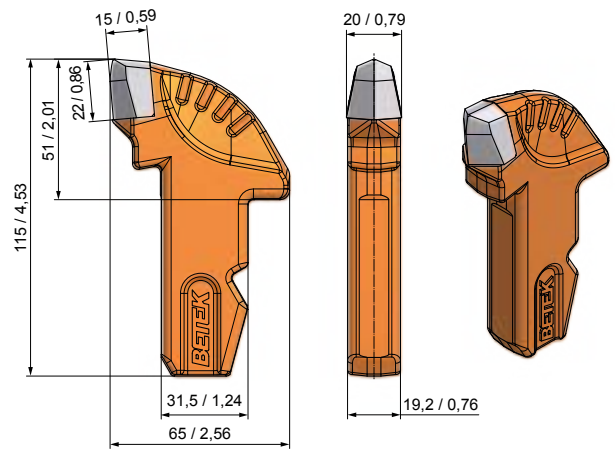

BF41

BF115x32x19/1

25

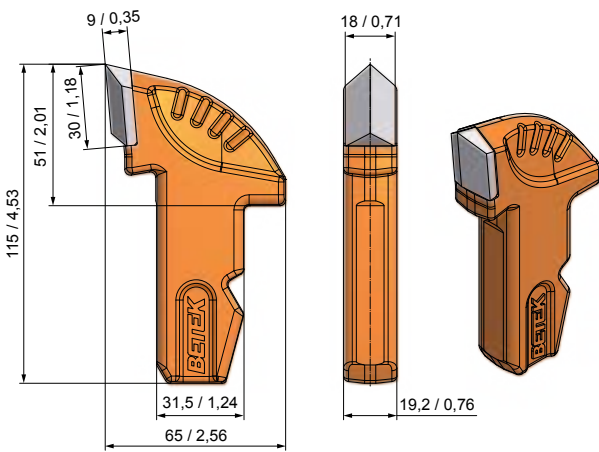

BF42

BF115x32x19/2

25

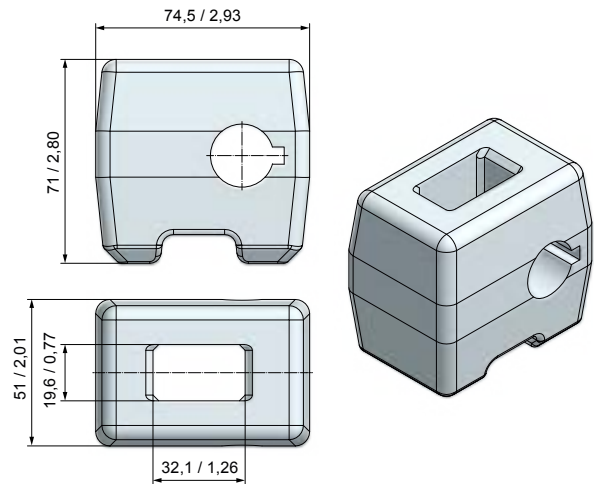

BHF15

BHF32x20

10

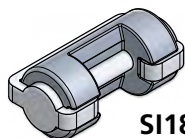

S1188

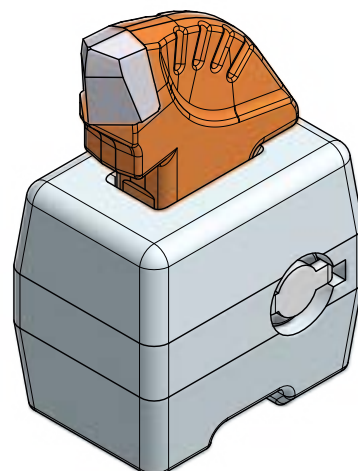

BETEK TungStuds with tungsten carbide core: Effective protection against wear for metal surfaces

BETEK TungStuds are on the front line when material is produced or processed. The TungStuds which are equipped with a tungsten carbide core are the first to come into contact with the material to be conveyed and are subjected to extreme abrasion. In addition to the wear protection through the TungStuds, the bound material to be conveyed is used as a material cushion. This means the direct abrasion of the metal surface due to the movement of materials is reduced.

Instead of expensive spare parts which may be required due to worn-down metal surfaces, it is only necessary to replace the TungStuds. When using BETEK TungStuds also the maintenance outlay is reduced. Because of their tungsten carbide core they can resist to the most extreme conditions.



Further information: www.betek.de/en/productprogramme/tungstuds

* Height subsequent to welding on

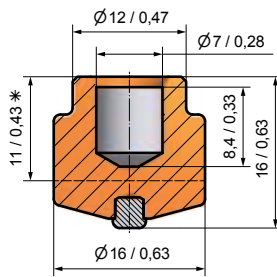

BTS01

BTSD16/16

150

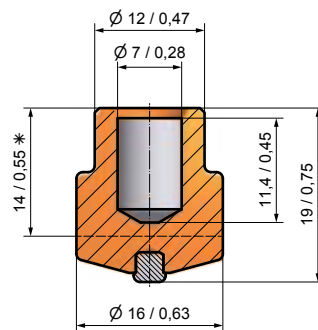

BTS02

BTSD16/19

150

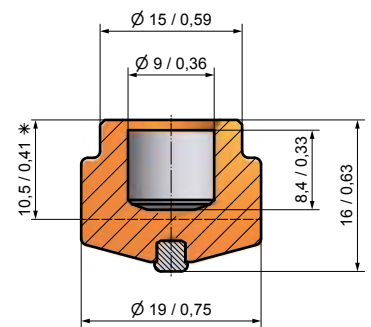

BTS03

BTSD19/16

150

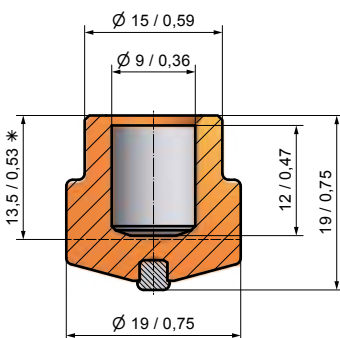

BTS04

BTSD19/19

150

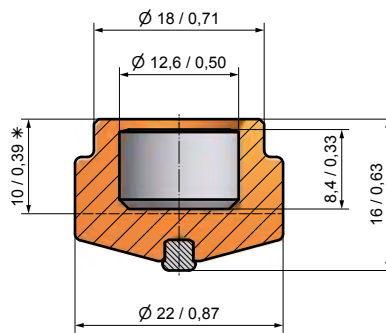

BTS05

BTSD22/16

100

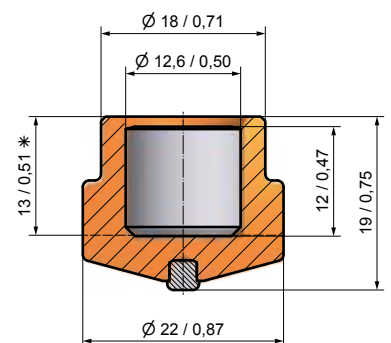

BTS06

BTSD22/19

100

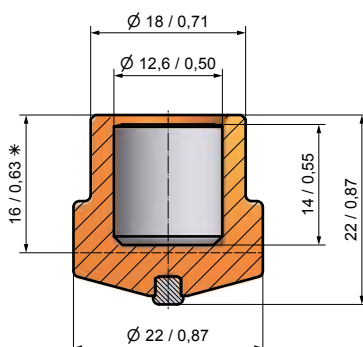

BTS07

BTSD22/22

100

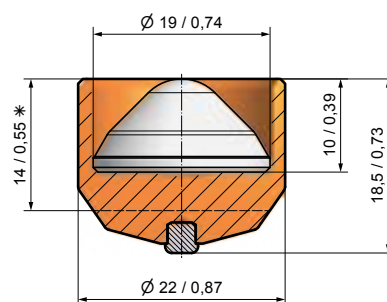

BTS08

BTSD22/18.5SG

100

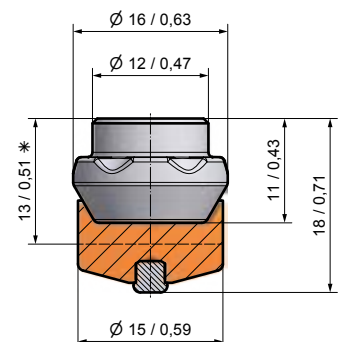

BTS10B

BTSD16/18B

150



US

GB

BETEK GmbH & Co. KG

Sulgener Str. 21 - 23
D-78733 Aichhalden
Germany

Service hotline + 49 (0) 74 22 / 5 65-591
Service fax line + 49 (0) 74 22 / 5 65-122

info@betek.de
www.betek.de

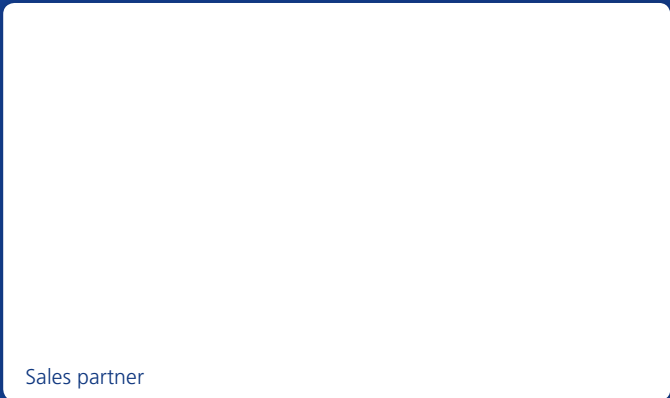

Sales partner

